

S.A. GLOBAL PRIVATE LIMITED

Regd. Office: Group Housing Site, Sector 77, SAS Nagar, Mohali - 140308, Punjab, India
M: 79863 53802, **E-mail:** saglobal@homelandregalia.com, **CIN:** U51225PB2016PTC052956
Website: www.homelandregalia.com, **SMS:** HOMELAND to 56767

Date: 09.11.2023

To,
The Additional Director
Ministry of Environment, Forest and Climate Change,
Integrated Regional Office,
Bay No. 24-25, Sector-31A,
Dakshin Marg,
Chandigarh- 160030
(Mail ids: eccompliance-nro@gov.in and ronz.chd-mef@nic.in)

Subject: Submission of six monthly compliance report for period ending 30.09.2023 for the Group Housing Project namely "Homeland Regalia" (formally known as Homeland Residences) located at sector 77, Distt. SAS Nagar (Mohali), Punjab by M/s S.A. Global Pvt. Ltd.

Respected Sir,

With reference to the EIA Notification & its amendments regarding submission of six monthly compliance report, we are hereby submitting the six monthly compliance report for period ending 30.09.2023 for the above said project through mail for your perusal.

Kindly acknowledge the receipt of the same.

Thanking you
Sincerely
For M/s S.A. Global Pvt. Ltd.

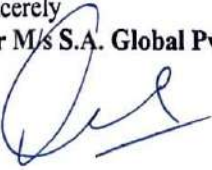

(Authorized Signatory)
Name: Gurbhagwant Singh
Contact No.: 7986353802
Designation: Authorised Representative
E-mail: saglobal@homelandregalia.com

CC: Member Secretary, SEIAA Punjab, Directorate of Environment and Climate Change, C/o Punjab State Council for Science & Technology, MGSIPA Complex, Sector 26, Chandigarh-160019

HOMELAND REGALIA



REGISTERED OFFICE: SECTOR 77, SAS NAGAR, MOHALI - 140308, PUNJAB, INDIA

PHONE: 7986353802

2023

**SIX MONTHLY COMPLIANCE
REPORT
(Period ending 30.09.2023)**

F
OR
For

**“Homeland Regalia” (formerly known as
Homeland Residences)”**
Sector-77, Distt. SAS Nagar (Mohali), Punjab

Project By:

M/s S.A. GLOBAL PVT. LTD.
Sector-77, Distt. SAS Nagar (Mohali), Punjab

Prepared by:



**Eco Paryavaran Laboratories and Consultants
Private Limited**

Eco Paryavaran Laboratories and Consultants Private Limited
E-207, Industrial Area, Phase-VIII B (Sector-74), Mohali (SAS Nagar),
Punjab 160071

Tele No.: 0172-4616225 **email:** compliance@ecoparyavaran.org

M: 098140-03103, 088720-43178

www.ecoparyavaran.org



CONTENT

S. No.	DESCRIPTION	Page No.
1.	Data Sheet	1-4
2.	Compliance of Environmental Clearance conditions	5-21
ANNEXURE		
3.	A-1: Copy of Environment Clearance Letter	22-34
4.	A-2(a): Construction status	35
5.	A-2(b): Site Photograph	36-39
6.	A-3(a): PWRDA Permission	40-41
7.	A-3(b): PWRDA application	42
8.	A-4: CTE Grant Certificate	43-46
9.	A-5: AAINOC	47-48
10.	A-6: Test Reports of Ambient Air, Noise, Soil & Water	49-55
11.	A-7: Copy of permission obtained from GMADA for water supply, sewerage connection, solid waste .	56-57
12.	A-8: PUC Certificate	58-60
13.	A-9(a): Traffic circulation plan	61
14.	A-9 (b): Traffic calming measures	62-66
15.	A-10: Advertisement in Newspaper	67-69
16.	A-11: (Homeland Regalia) website screenshot	70-71
17.	A-12: Screenshot of mail regarding submission compliance report for period ending 31.03.2023.	72
18.	A-13 : Receiving of submission of Form –V and Screenshot showing uploaded Form-V on company’s website	73-74
19.	A-14 : Structural Safety Certificate	75
20.	A-15 : EC Application Status and submission of the application	76-78

**New Ministry of Environment, Forest and Climate Change
Northern Regional Office,
Chandigarh-160030**

DATA SHEET

1.	Project Type	Group Housing Project
2.	Name of the Project	“Homeland Regalia” (formerly known as Homeland Residences)
3.	Clearance letter (s)/O.M No. & dates	Environment Clearance has been granted by MoEF&CC vide Letter F. No. 21-110/2020-IA-III dated 23.02.2021. Copy of the EC letter is attached along as Annexure 1 .
4.	Location	Sector-77, (Opposite Gurudwara Mata Sundar Kaur), District SAS Nagar, Mohali.
	a) District (s)	SAS Nagar (Mohali)
	b) State (s)	Punjab
	c) Latitudes/ Longitudes	30°41'47.96"N and 76°42'19.16"E
5.	Address for correspondence	Mr. Gurbhagwant Singh (Authorized signatory) M/s S.A. Global Pvt. Ltd. Group Housing Site, Sector -77, SAS Nagar, Mohali -140308, Punjab. 8437800228; 7986353802 saglobal@homelandregalia.com
6.	Salient features	
	a) of the project	As per the Environment Clearance, the total plot area of the project is 18,536.082 sq. m. and the built up area of the project is 1,00,287.509 sq. m. The project comprises of 6 residential towers (303 residential flats) and 18 shops.
	b) of the environmental management plans	As per the Environment Clearance, the total water requirement for the project will be 122 KLD and same will be met by 92 KLD of fresh water from GMADA Supply and 30 KLD of recycled water. The total wastewater generation from the project will be 98 KLD which will be

		treated in STP of capacity 150 KLD. The total quantity of solid waste generation from the project will be 580 kg/day.								
7.	Break-up of the project area									
	a) Submergence area: Forest and Non-forest	Not applicable								
	b) Others	Not applicable								
8.	Break-up of project affected population with enumeration of those losing houses/dwelling units only, agricultural land only both dwelling units and agricultural land and landless labourers/artisans.	Not applicable								
	a) SC/ST/Adivasis	Not applicable								
	b) Others <i>(Please indicate whether these figures are based on any scientific and systematic survey carried out or only provisional figures. If a survey has been carried out give details and year of survey)</i>	Not applicable								
9.	Financial details:									
	a) Project cost as originally planned and subsequent revised estimates and the year of price reference.	Original planned project cost: Rs. 300 Crores Revised total project cost is Rs.320 Crores.								
	b) Allocations made for environmental management plans with item wise and year wise break up.	Rs. 166 Lakhs has been reserved for EMP during construction phase as capital cost. While, Rs. 12 Lakhs and 12.6 Lakhs has been planned to be reserved for EMP during construction and operation phase as recurring cost per annum respectively. Breakup of EMP during construction phase:								
		<table border="1"> <thead> <tr> <th>Sr. No.</th> <th>Title</th> <th>Capital Cost (in Lakhs)</th> <th>Recurring Cost (in Lakhs/Annum)</th> </tr> </thead> <tbody> <tr> <td></td> <td></td> <td></td> <td></td> </tr> </tbody> </table>	Sr. No.	Title	Capital Cost (in Lakhs)	Recurring Cost (in Lakhs/Annum)				
Sr. No.	Title	Capital Cost (in Lakhs)	Recurring Cost (in Lakhs/Annum)							

1.	Air Pollution Control	5	0.5
2.	Water Pollution Control/ STP	35	1.5
3.	Noise Pollution Control	1	0.5
4.	Landscaping	20	3
5.	Solid Waste Management	10	2
6.	Rain water Recharging	15	0.5
7.	Energy Conservation	80	2
8.	Environmental Monitoring	-	2
Total		166	12

Breakup of EMP during Operation phase:

Sr.No.	Title	Recurring Cost (in Lakhs/Annum)
1.	Air Pollution Control	0.5
2.	Water Pollution Control/ STP	5
3.	Noise Pollution Control	0.10
4.	Landscaping	2
5.	Solid Waste Management	1
6.	Rain water Recharging	1.5
7.	Energy Conservation	0.5
8.	Environmental Monitoring	2
Total		Rs. 12.6

c) Benefit cost ratio/internal rate of return and the year of assessment

Will be calculated and submitted.

d) Whether (c) includes the cost of environmental management as shown in b) above.

Yes

	e) Actual expenditure incurred on the project so far.	Rs.147,49 Cr. (including land cost) has been incurred on the project till 30.09.2023.
	f) Actual expenditure incurred on environmental management plans so far.	Rs. 4,95,876/- have been spent on EMP till 30.09.2023.
10.	Forest land requirement:	
	a) the status of approval for diversion of forest land for non-forestry use	Not Applicable.
	b) the status of clear felling, if any	Not Applicable.
	c) the status of compensatory afforestation, if any.	Not Applicable.
	d) Comments on the viability & sustainability of compensatory Afforestation programme in the light of actual field experience so far.	Not Applicable.
11.	The status of clear felling in non-forest areas (such as submergence area of reservoir, approach road) if any, with quantitative information	Not applicable
12.	Status of construction:	The project is in construction phase. Detailed construction status of the project is attached as Annexure-2(a) . Photographs of project site showing the current construction status is attached along as Annexure 2(b) .
	a) Date of commencement (actual and/or planned)	Actual date of commencement- March, 2022.
	b) Date of completion (actual and/or planned)	Planned date of completion- February, 2028.
13.	Reasons for the delay, if the project is yet to start	Not applicable

Compliance Report on conditions imposed in Environmental Clearance for Period ending 30.09.2023

PART-A- Specific Conditions

Sr. No.	Conditions	Reply
1.	Explore the possibility of 100% utilization of excess of treated water. The PP should consider diverting the excess treated water for use in nearby construction sites. The PP should approach GMADA for the purpose.	Agreed. Treated water from STP will be reused for flushing purposes, green area development and excess water will be disposed to GMADA sewer or nearby construction activities.
2.	PP should explore enhancing energy conservation up to at least 5%.	Noted. Energy Conservation Building Code will be followed to enhance the conservation of energy.
3.	As committed, no groundwater abstraction shall be done during construction as well as operation phase of the project.	Agreed. Earlier, it was proposed that water requirement will be met through GMADA supply. However, Ad- Interim permission for groundwater abstraction has also been obtained from PWRDA. Copy of PWRDA permission is attached along as Annexure-3 (a) . Further, an online application for ground water extraction has already been applied on PWRDA portal vide dated 16.09.2023. Copy of acknowledgment showing the same is attached as Annexure-3 (b) .
4.	Fresh water requirement from local authority shall not exceed 92 KLD during operational phase.	Fresh water requirement will not exceed the approved quantity during operational phase.
5.	Trees cutting/ transplantation shall be subject to prior permission from the concerned local Authority. Compensatory plantation in the ratio of 1:10 (i.e., planting of 10 trees for every 1 tree that is cut) shall be done and maintained. Plantations to be ensured species (cut) to species (planted).	Noted.
6.	Area for greenery shall be provided as per the details provided in the project document i.e., area under plantation/ greenery will be 2,855.16 sq. m. As proposed, at least 240 trees to be maintained during the operation phase of the project. The landscape planning should include	Adequate green area will be provided within the project premises and will be maintained during the operation phase. Native species of evergreen tall and ornamental trees have been proposed to be planted inside the premises

	<p>plantation of native species. A minimum of 01 tree for every 80 sq.m of land should be planted and maintained. The existing trees will be counted for this purpose. Plantations to be ensured species (cut) to species (planted). The species with heavy foliage, broad leaves and wide canopy cover are desirable. Water intensive and/or invasive species should not be used for landscaping.</p>	<p>and will be maintained during the operation phase.</p>
7.	<p>As proposed, waste water shall be treated in an onsite STP of total 150 KLD capacity. The treated water from the STP shall be recycled and reused for flushing (at least 30 KLD) and for gardening (at least 16 KLD).</p>	<p>STP of adequate capacity will be installed within the project and treated water from the STP will be recycled and reused for flushing and gardening purpose.</p>
8.	<p>The project proponents would commission a third-party study on the implementation of conditions related to quality and quantity of recycle and reuse of treated water, efficiency of treatment systems, quality of treated water being supplied for flushing (specially the bacterial counts), comparative bacteriological studies from toilet seats using recycled treated waters and fresh waters for flushing, and quality of water being supplied through spray faucets attached to toilet seats.</p>	<p>For implementation of conditions related to quality and quantity of recycle and reuse of treated water, efficiency of treatment systems etc., a third party study will be commissioned.</p>
9.	<p>The local bye-law provisions on rain water harvesting should be followed. If local bye-law provision is not available, adequate provision for storage and recharge should be followed as per the Ministry of Urban Development Model Building Byelaws, 2016. As proposed, five RWH pits shall be provided for rain water harvesting after filtration.</p>	<p>Total 5 Rain water recharging pits have been proposed for artificial rain water recharge within the project premises.</p>
10.	<p>The solid waste shall be duly segregated into biodegradable and non-biodegradable components and handled in separate area earmarked for segregation of solid waste. As committed, biodegradable waste shall be composted by use of Composter. Inert waste shall be dumped to authorized site. The recyclable waste shall be sold to re-sellers.</p>	<p>Solid waste will be segregated at the source as biodegradable and non-biodegradable components. The recyclable waste will be sold to re-sellers. Bio-degradable waste will be composted by composter and inert waste will be dumped to authorized dumping site. Solid waste generated will be handled & disposed off as per the Solid Waste Management Rules, 2016.</p>

11.	The PP shall also provide electric charging points in the parking areas for e-vehicles as committed.	Points for electric charging in the parking areas for e-vehicles will be provided.
12.	The Environmental Clearance to the project is primarily under provisions of EIA Notification, 2006. The Project Proponent is under obligation to obtain approvals / clearances under any other Acts/ Regulations or Statutes as applicable to the project.	Required approvals are being obtained in time as applicable for the project.

PART-B- Standard Conditions:

1. Statutory compliance:

Sr. No.	Conditions	Reply
1.	The project proponent shall obtain all necessary clearance/ permission from all relevant agencies including town planning authority before commencement of work. All the construction shall be done in accordance with the local building byelaws.	All necessary permissions are being obtained simultaneously. Further, construction work is being done in accordance with the local building byelaws. Site photographs showing status of the construction status is attached as Annexure 2(b) .
2.	The approval of the Competent Authority shall be obtained for structural safety of buildings due to earthquakes, adequacy of firefighting equipment etc. as per National Building Code including protection measures from lightening etc.	Agreed. The building is designed by approved Structural engineer as per the NBC guidelines and seismic zone IV. Further, Structural safety certificate has been obtained and is attached as Annexure 14 .
3.	The project proponent shall obtain forest clearance under the provisions of Forest (Conservation) Act, 1980, in case of the diversion of forest land for non-forest purpose involved in the project.	Not required as no forest land is involved in the project.
4.	The project proponent shall obtain clearance from the National Board for Wildlife, if applicable.	The project does not fall in eco-sensitive zone of any bird or wildlife sanctuary. Thus, NBWL clearance is not required
5.	The project proponent shall obtain Consent to Establish / Operate under the provisions of Air (Prevention & Control of Pollution) Act, 1981 and the Water (Prevention & Control of	Consent to Establish (CTE) and its extension has already been obtained from PPCB. Copy

	Pollution) Act, 1974 from the concerned State Pollution Control Board/ Committee.	of grant certificates is attached as Annexure-4.
6.	The project proponent shall obtain the necessary permission for drawl of ground water / surface water required for the project from the competent authority.	Permission from PWRDA for ground water extraction has been obtained vide PWRDA08/2021/L2/178 dated 02.08. 2021. Copy of PWRDA permission is attached along as Annexure-3(a) . Further, an online application for ground water extraction has already been applied on PWRDA portal vide dated 16.09.2023. Copy of acknowledgment showing the same is attached as Annexure-3 (b) .
7.	A certificate of adequacy of available power from the agency supplying power to the project along with the load allowed for the project should be obtained.	Agreed and same will be complied.
8.	All other statutory clearances such as the approvals for storage of diesel from Chief Controller of Explosives, Fire Department, Civil Aviation Department shall be obtained, as applicable, by project proponents from the respective competent authorities.	The statutory clearances are being obtained as & when required. Approval has been obtained from Airport Authority of India; copy of same is attached along as Annexure-5.
9.	The provisions of the Solid Waste Management Rules, 2016, e-Waste (Management) Rules, 2016, and the Plastics Waste Management Rules, 2016, shall be followed.	The provisions of the Solid Waste Management Rules, 2016, e-Waste Management Rules, 2016 and Plastic Waste Management Rules, 2016, will be complied accordingly.
10.	The project proponent shall follow the ECBC/ECBC-R prescribed by Bureau of Energy Efficiency, Ministry of Power strictly.	Agreed. ECBC/ECBC-R prescribed by Bureau of Energy Efficiency, Ministry of Power will be followed strictly.

2. Air quality monitoring and preservation:

Sr. No.	Conditions	Reply
1.	Notification GSR 94(E) dated 25.01.2018 of MoEF&CC regarding Mandatory Implementation of Dust Mitigation Measures for Construction and Demolition Activities for projects requiring Environmental Clearance shall be complied with.	Adequate dust mitigation measures like water sprinkling are being followed during construction phase.
2.	A management plan shall be drawn up and implemented to contain the current exceedance in ambient air quality at the site.	All necessary steps are being implemented to minimize the air pollution at the project site and water sprinklers are being installed to improve the air quality during construction phase.
3.	The project proponent shall install system to carry out Ambient Air Quality monitoring for common/ criterion parameters relevant to the main pollutants released (e.g. PM 10 and PM 2.5) covering upwind and downwind directions during the construction period.	Regular ambient air quality monitoring is being carried out after every six months by MoEF&CC and NABL Accredited laboratory. Latest Test reports for the last conducted monitoring is attached as Annexure-6 . Further, it is to assure you that Ambient Air Quality monitoring station will be installed within time frame of one month.
4.	Diesel power generating sets proposed as source of backup power should be of enclosed type and conform to rules made under the Environment (Protection) Act, 1986. The height of stack of DG sets should be equal to the height needed for the combined capacity of all proposed DG sets. Use of low Sulphur diesel. The location of the DG sets may be decided with in consultation with State Pollution Control Board.	DG sets with adequate stack height conforming to rules made under the Environment (Protection) Act, 1986 will be provided.
5.	Construction site shall be adequately barricaded before the construction begins. Dust, smoke & other air pollution prevention measures shall be provided for the building as well as the site. These measures shall include screens for the building under construction, continuous dust/ wind breaking walls all around the site (at least 3-meter height). Plastic/ tarpaulin sheet covers shall be provided for vehicles bringing in sand, cement, murrum and other construction materials prone to causing dust pollution at the site as well as taking out debris from the site.	All necessary adequate steps are being/will be followed to minimize the air pollution during the construction phase. The vehicles bringing in sand, cement etc., and other construction materials to the project site are covered in plastic/tarpaulin sheets.
6.	Sand, murrum, loose soil, cement, stored on site shall be covered adequately so as to prevent dust pollution.	Adequate measures are being complied to mitigate the effects of dust pollution at the project site.

7.	Wet jet shall be provided for grinding and stone cutting.	Agreed. Wet jet will be provided for grinding and stone cutting.
8.	Unpaved surfaces and loose soil shall be adequately sprinkled with water to suppress dust.	Agreed and complied, regular water sprinkling is being done to suppress dust at construction site.
9.	All construction and demolition debris shall be stored at the site (and not dumped on the roads or open spaces outside) before they are properly disposed. All demolition and construction waste shall be managed as per the provisions of the Construction and Demolition Waste Management Rules 2016.	All the construction and demolition debris will be managed as per the provisions of Construction and Demolition Rules, 2016 throughout the construction phase of the project.
10.	The diesel generator sets to be used during construction phase shall be low Sulphur diesel type and shall conform to Environmental (Protection) prescribed for air and noise emission standards.	Diesel generator sets used during construction conform to Environmental (Protection) prescribed for air and noise emission standards.
11.	The gaseous emissions from DG set shall be dispersed through adequate stack height as per CPCB standards. Acoustic enclosure shall be provided to the DG sets to mitigate the noise pollution. Low Sulphur diesel shall be used. The location of the DG set and exhaust pipe height shall be as per the provisions of the Central Pollution Control Board (CPCB) norms.	Agreed and complied. Adequate stack height as well as acoustic enclosure are provided with DG sets at the construction site.
12.	For indoor air quality the ventilation provisions as per National Building Code of India.	National Building Code will be followed throughout the project during construction phase also.

3. Water Quality Monitoring and Preservation:

Sr. No.	Conditions	Reply
1.	The natural drain system should be maintained for ensuring unrestricted flow of water. No construction shall be allowed to obstruct the natural drainage through the site, on wetland and water bodies. Check dams, bio-swales, landscape, and other sustainable urban drainage systems (SUDS) are allowed for maintaining the drainage pattern and to harvest rain water.	It is being ensured that natural drainage system is maintained for unrestricted flow of water during the construction and the operational phase of the project.

2.	Buildings shall be designed to follow the natural topography as much as possible. Minimum cutting and filling should be done.	Minimum cutting and filling will be done and building will be designed so natural topography will be followed.
3.	Total fresh water use shall not exceed the proposed requirement as provided in the project details.	Total fresh water used will not exceed the proposed requirement as provided in the project details.
4.	The quantity of fresh water usage, water recycling and rainwater harvesting shall be measured and recorded to monitor the water balance as projected by the project proponent. The record shall be submitted to the Regional Office, MoEF&CC along with six monthly Monitoring reports.	Records of fresh water usage, water recycling and rainwater harvesting will be maintained. The record will be submitted to the Regional Office, MoEF&CC along with six monthly monitoring reports.
5.	A certificate shall be obtained from the local body supplying water, specifying the total annual water availability with the local authority, the quantity of water already committed, the quantity of water allotted to the project under consideration and the balance water available. This should be specified separately for ground water and surface water sources, ensuring that there is no impact on other users.	Agreed and complied. Approval for water supply has been obtained from GMADA vide letter no. GMADA/CE/2020/1957 dated 22.12.2020 and Letter No. GMADA /M.NG(JS-1)/2023/2057 dated 20.07.2023. Permission for groundwater abstraction has also been obtained from PWRDA. Copy of PWRDA permission is attached along as Annexure-3 (a) . Further, an online application for ground water extraction has already been applied on PWRDA portal vide dated 16.09.2023. Copy of acknowledgment showing the same is attached as Annexure-3 (b) .
6.	At least 20% of the open spaces as required by the local building byelaws shall be pervious. Use of Grass pavers, paver blocks with at least 50% opening, landscape etc. would be considered as pervious surface.	Agreed and accepted. It is already being complied.
7.	Installation of dual pipe plumbing for supplying fresh water for drinking, cooking and bathing etc., and other for supply of recycled water for flushing, landscape irrigation, car washing, thermal cooling, conditioning etc. shall be done.	Dual plumbing system will be provided within the project for reuse of treated wastewater for flushing as well as for green area.
8.	Use of water saving devices/fixtures (viz. low flow flushing system; use of low flow faucets tap aerators etc.) for water conservation shall be incorporated in the building plan.	In order to minimize the use of water, low fixtures will be provided as water saving devices. Therefore, water conservation will be included in the building plan.

9.	Separation of grey and black water should be done by the use of dual plumbing system. In case of single stack system separate recirculation lines for flushing by giving dual plumbing system be done.	Dual plumbing system will be provided within the project.
10.	Water demand during construction should be reduced by use of premixed concrete, curing agents and other best practices referred.	Agreed, water demand during construction phase is being reduced by the use of premixed concrete and curing agents.
11.	The local bye-law provisions on rain water harvesting should be followed. If local bye-law provision is not available, adequate provision for storage and recharge should be followed as per the Ministry of Urban Development Model Building Byelaws, 2016. Rain water harvesting recharge pits/ storage tanks shall be provided for ground water recharging as per the CGWB norms.	Total 5 Rain water recharging pits have been proposed for artificial rain water recharge within the project premises as stated in the CGWB norms.
12.	A rain water harvesting plan needs to be designed where the recharge bores of minimum one recharge bore per 5,000 square meters of built up area and storage capacity of minimum one day of total fresh water requirement shall be provided. In areas where ground water recharge is not feasible, the rain water should be harvested and stored for reuse. The ground water shall not be withdrawn without approval from the Competent Authority.	Rain water harvesting system will be designed as suggested. Total 5 Rain water recharging pits have been proposed for artificial rain water recharge within the project premises. Earlier, it was proposed that water requirement will be met through GMADA supply.
13.	All recharge should be limited to shallow aquifer.	Noted. Same will be complied.
14.	No ground water shall be used during construction phase of the project.	No use of groundwater is being done for construction phase of the project.
15.	Any ground water dewatering should be properly managed and shall conform to the approvals and the guidelines of the CGWA in the matter. Formal approval shall be taken from the CGWA for any ground water abstraction or dewatering.	Ground water dewatering is not involved in the project.
16.	The quantity of fresh water usage, water recycling and rainwater harvesting shall be measured and recorded to monitor the water balance as projected by the project proponent. The record shall be submitted to the Regional	Noted, records of quantity of fresh water usage, water recycling and rainwater harvesting will be maintained. The record will be submitted to the Regional Office,

	Office, MoEF&CC along with six monthly Monitoring reports.	MoEF&CC along with six monthly Monitoring reports.
17.	Sewage shall be treated in the STP with tertiary treatment. The treated effluent from STP shall be recycled/ re-used for flushing, AC make up water and gardening. As proposed, no treated water shall be disposed in to municipal drain.	Noted, STP of adequate capacity will be installed at the project site for treatment of wastewater to be generated during operational phase. Treated water from STP will be recycled for flushing, landscaping, etc. No treated water will be disposed into municipal drain.
18.	No sewage or untreated effluent water would be discharged through storm water drains.	Noted, no sewage or untreated effluent water will be discharged through storm water drains. Wastewater generated from operation phase will be treated in STP and treated water will be recycled for flushing, landscaping, etc.
19.	Onsite sewage treatment of capacity of treating 100% waste water to be installed. The installation of the Sewage Treatment Plant (STP) shall be certified by an independent expert and a report in this regard shall be submitted to the Ministry before the project is commissioned for operation. Treated waste water shall be reused on site for landscape, flushing, cooling tower, and other end-uses. Excess treated water shall be discharged as per statutory norms notified by Ministry of Environment, Forest and Climate Change. Natural treatment systems shall be promoted.	STP of adequate capacity will be installed at the project site for treatment of wastewater to be generated during operational phase. Treated water from STP will be reused on the site for flushing, landscaping, etc. and only excess will be discharged into GMADA sewer.
20.	Periodically monitoring of water quality of treated sewage shall be conducted. Necessary measures should be made to mitigate the odour problem from STP.	Treated sewage will be regularly monitored once treatment facility is provided at the project site. Measures to mitigate the odor problem from STP will be implemented.
21.	Sludge from the onsite sewage treatment, including septic tanks, shall be collected, conveyed and disposed as per the Ministry of Urban Development, Central Public Health and Environmental Engineering Organization (CPHEEO) Manual on Sewerage and Sewage Treatment Systems, 2013.	STP sludge generated from proposed STP will be utilized for landscaping within the project only.

4. Noise Monitoring and Prevention:

Sr. No.	Conditions	Reply
1.	Ambient noise levels shall conform to residential area/ commercial area/ industrial area/ silence zone both during day and night as per Noise Pollution (Control and Regulation) Rules, 2000. Incremental pollution loads on the ambient air and noise quality shall be closely monitored during construction phase. Adequate measures shall be made to reduce ambient air and noise level during construction phase, so as to conform to the stipulated standards by CPCB / SPCB.	Agreed, Incremental pollution loads on ambient air and noise quality are being closely monitored. Recent test report of environmental monitoring done is enclosed as Annexure-6 .
2.	Noise level survey shall be carried as per the prescribed guidelines and report in this regard shall be submitted to Regional Officer of the Ministry as a part of six-monthly compliance report.	Ambient noise levels are being monitored and maintained regularly during construction phase. Recent test report is enclosed as Annexure-6 .
3.	Acoustic enclosures for DG sets, noise barriers for ground-run bays, ear plugs for operating personnel shall be implemented as mitigation measures for noise impact due to ground sources.	Acoustic enclosure for DG sets, ear plugs for construction labors have been provided as mitigation measure for noise impact due to ground sources.

5. Energy Conservation Measures:

Sr. No.	Conditions	Reply
1.	Compliance with the Energy Conservation Building Code (ECBC) of Bureau of Energy Efficiency shall be ensured. Buildings in the States which have notified their own ECBC, shall comply with the State ECBC.	Noted, ECBC guidelines are being followed in the project so as to comply with the bureau of energy efficiency.
2.	Outdoor and common area lighting shall be LED.	Agreed. LED lighting will be provided at the project site for outdoor and common area lighting.
3.	Concept of passive solar design that minimize energy consumption in buildings by using design elements, such as building orientation, landscaping, efficient building envelope, appropriate fenestration, increased day lighting design and thermal mass etc. shall be incorporated in the building design. Wall, window, and roof u-values shall be as per ECBC specifications.	ECBC guidelines are being followed in the project and concept of passive solar design will be implemented so as to minimize energy consumption in the buildings with the use of design elements such as landscaping, efficient building envelope etc.

4.	Energy conservation measures like installation of CFLs/ LED for the lighting the area outside the building should be integral part of the project design and should be in place before project commissioning.	Adequate energy conservation measures will be followed in the project to conserve energy. Also, use of LED's and solar street lights is proposed in all common areas and the residents shall be educated about the huge savings in their electricity bills, if they use the LED.
5.	Solar, wind or other Renewable Energy shall be installed to meet electricity generation equivalent to 1% of the demand load or as per the state level/ local building bye-law's requirement, whichever is higher.	Agreed and accepted. The solar, wind or other renewable energy will be installed to meet electricity generation equivalent to 1% of the demand load or as per the state level/ local building bye-law's requirement. Also, Solar panels is being installed on roof top of the project and adequate roof top area has been reserved for solar panels.
6.	Solar power shall be used for lighting in the apartment to reduce the power load on grid. Separate electric meter shall be installed for solar power. Solar water heating shall be provided to meet 20% of the hot water demand of the commercial and institutional building or as per the requirement of the local building bye-laws, whichever is higher. Residential buildings are also recommended to meet its hot water demand from solar water heaters, as far as possible.	Solar lights will be provided at the project for illumination of common areas. Separate electric meter will be installed for solar power. Solar water heater will be provided to meet 20% of the hot water demand of the commercial and institutional building or as per the requirements of local building bye-laws.

6. Waste Management:

Sr. No.	Conditions	Reply
1.	A certificate from the competent authority handling municipal solid wastes, indicating the existing civic capacities of handling and their adequacy to cater to the M.S. W. generated from project shall be obtained.	Agreed, solid waste will be collected, stored and disposed off as per Solid Waste Management Rules, 2016. Permission from GMADA regarding solid waste disposal has been obtained and copy of same is enclosed as Annexure-7 .
2.	Disposal of muck during construction phase shall not create any adverse effect on the neighboring communities and be disposed taking the necessary precautions for general safety and health aspects of people, only in approved sites with the approval of competent authority.	Agreed, during the construction phase of the project, no muck will be disposed outside the premises, thus, no adverse effect is being created on the neighboring communities.
3.	Separate wet and dry bins must be provided in each unit and at the ground level for facilitating segregation of waste. Solid waste shall be segregated into wet garbage and inert materials.	Noted, separate wet and dry bins are being provided for segregation of solid waste into wet materials and inert materials during construction phase and same will be maintained during operational phase.

4.	Organic waste compost/ Vermi-culture pit/ Organic Waste Converter within the premises with a minimum capacity of 0.3 kg / person/ day must be installed.	Agreed, composter will be installed for management of biodegradable waste at the project site.
5.	All non-biodegradable waste shall be handed over to authorized recyclers for which a written tie up must be done with the authorized recyclers.	The non-biodegradable waste will be sent to authorized recyclers.
6.	Any hazardous waste generated during construction phase, shall be disposed off as per applicable rules and norms with necessary approvals of the State Pollution Control Board.	Agreed.
7.	Use of environment friendly materials in bricks, blocks and other construction materials, shall be required for at least 20% of the construction material quantity. These include Fly Ash bricks, hollow bricks, AACs, Fly Ash Lime Gypsum blocks, Compressed earth blocks, and other environment friendly materials.	Noted. Same will be complied.
8.	Fly ash should be used as building material in the construction as per the provision of Fly Ash Notification of September, 1999 and amended as on 27th August, 2003 and 25th January, 2016. Ready mixed concrete must be used in building construction.	Noted. Same will be complied.
9.	Any wastes from construction and demolition activities related thereto shall be managed so as to strictly conform to the Construction and Demolition Waste Management Rules, 2016.	The construction waste is being managed as per Construction and Demolition Rules, 2016.
10.	Used CFLs and TFLs should be properly collected and disposed off/ sent for recycling as per the prevailing guidelines/ rules of the regulatory authority to avoid mercury contamination.	The used CFL's and TFL's will be properly collected and disposed off or will be sent for recycling as per the guidelines to avoid mercury contamination.

7. Green Cover:

Sr. No.	Conditions	Reply
1.	No tree can be felled/ transplant unless exigencies demand. Where absolutely necessary, tree felling shall be with prior permission from the concerned regulatory authority. Old trees should be retained based on girth and age regulations as may be prescribed by the Forest Department. Plantations to be ensured species (cut) to species (planted).	Noted.
2.	Topsoil should be stripped to a depth of 20 cm from the areas proposed for buildings, roads, paved areas, and external services. It should be stockpiled appropriately in designated areas and reapplied during plantation of the proposed vegetation on site.	The top soil excavated during construction activities will be used for landscaping within the project premises.

8. Transport:

Sr. No.	Conditions	Reply
1.	A comprehensive mobility plan, as per MoI-JD best practices guidelines (URDPFI), shall be prepared to include motorized, non-motorized, public, and private networks. Road should be designed with due consideration for environment, and safety of users. The road system can be designed with these basic criteria. <ul style="list-style-type: none"> • Hierarchy of roads with proper segregation of vehicular and pedestrian traffic. • Traffic calming measures. • Proper design of entry and exit points. • Parking norms as per local regulation. 	Noted. Mobility plan will be prepared to include motorized, non-motorized, public, and private networks. Roads have been designed considering the environment and safety of users. Traffic circulation Plan along with traffic calming measures is enclosed as Annexure 9(a) & 9(b) respectively.
2.	Vehicles hired for bringing construction material to the site should be in good condition and should have a pollution check certificate and should conform to applicable air and noise emission standards be operated only during non-peak hours.	Vehicles hired for bringing construction material are having valid PUC certificates and copy of some PUC certificate is enclosed as Annexure-8 .
3.	A detailed traffic management and traffic decongestion plan shall be drawn up to ensure that the current level of service of the roads within a 05 kms radius of the project is maintained and improved upon after the implementation of the project. This plan should be based on cumulative impact of all development and increased habitation being carried out or proposed to be carried out by the project or other agencies in this 05 Km radius of	Noted. Detailed traffic management and traffic decongestion plan will be drawn to ensure that current level of service of roads within a 5 kms radius of the project is maintained and improved when the project is implemented. Traffic circulation Plan along with traffic calming measures is

	the site in different scenarios of space and time and the traffic management plan shall be duly validated and certified by the State Urban Development department and the P.W.D./ competent authority for road augmentation and shall also have their consent to the implementation of components of the plan which involve the participation of these departments.	enclosed as Annexure 9(a) & 9(b) respectively.
--	---	---

9. Human Health Issues:

Sr. No.	Conditions	Reply
1.	All workers working at the construction site and involved in loading, unloading, carriage of construction material and construction debris or working in any area with dust pollution shall be provided with dust mask.	Agreed. Personal Protection Equipment (PPE) kits & dust mask are being provided to workers for safety who are involved in loading, unloading, carriage of construction material, construction debris etc.
2.	For indoor air quality the ventilation provisions as per National Building Code of India.	Agreed. The ventilation provisions as per National Building Code will be followed for indoor air quality.
3.	Emergency preparedness plan based on the Hazard identification and Risk Assessment (HIRA) and Disaster Management Plan shall be implemented.	Agreed. Emergency plan based on Hazard identification and Risk Assessment and Disaster Management Plan will be implemented.
4.	Provision shall be made for the housing of construction labor within the site with all necessary infrastructure and facilities such as fuel for cooking, mobile toilets, mobile STP, safe drinking water, medical health care, crèche etc. The housing may be in the form of temporary structures to be removed after the completion of the project.	Agreed. All necessary facilities like housing, fuel for cooking, medical checkup, mobile toilets etc. are provided to the construction labors at project site.
5.	Occupational health surveillance of the workers shall be done on a regular basis.	Health check-up of the workers is being done on regular basis.
6.	A First Aid Room shall be provided in the project both during construction and operations of the project.	First aid box is provided at construction site and will also be maintained during the operational phase of the project.

10. Miscellaneous:

Sr. No.	Conditions	Reply
1.	The project proponent shall prominently advertise it at least in two local newspapers of the District or State, of which one shall be in the vernacular language within seven days indicating that the project has been accorded environment clearance and the details of MoEF&CC/ SEIAA website where it is displayed.	Advertisements have been published in the local newspapers. Copy of advertisements are enclosed as Annexure-10 .
2.	The copies of the environmental clearance shall be submitted by the project proponents to the Heads of local bodies, Panchayats and Municipal Bodies in addition to the relevant offices of the Government who in turn has to display the same for 30 days from the date of receipt.	Agreed. The copies of environmental clearances has been submitted to the heads of local bodies, Panchayats and Municipal bodies.
3.	The project proponent shall upload the status of compliance of the stipulated environment clearance conditions, including results of monitored data on their website and update the same on half-yearly basis.	Agreed. Status of compliance of the stipulated environment clearance conditions, including results of monitored data are being uploaded on the company's website, screenshot showing the same is attached as Annexure-11 .
4.	The project proponent shall submit six-monthly reports on the status of the compliance of the stipulated environmental conditions on the website of the ministry of Environment, Forest and Climate Change at environment clearance portal.	Noted. Six monthly compliance reports of the stipulated EC conditions including results of monitored data are being regularly submitted to the respective offices. Screenshot of the mail showing the submission of compliance to MoEF&CC is attached as Annexure- 12 .
5.	The company shall have a well laid down environmental policy duly approved by the Board of Directors. The environmental policy should prescribe for standard operating procedures to have proper checks and balances and to bring into focus any infringements/deviation/violation of the environmental / forest / wildlife norms / conditions. The company shall have defined system of reporting infringements / deviation / violation of the environmental / forest / wildlife norms / conditions and / or shareholder's / stake	Agreed. Environment policy laid down by the board of directors prescribing for standard operating procedures to have proper checks and balances will be implemented.

	holders. The copy of the board resolution in this regard shall be submitted to the MoEF&CC as a part of six-monthly report.	
6.	A separate Environmental Cell both at the project and company head quarter level, with qualified personnel shall be set up under the control of senior Executive, who will directly report to the head of the organization.	Noted and Agreed. Environmental Monitoring Cell has been constituted for the project and names of persons involved are given below: 1. Mr. Gurbhagwant Singh 2. Mr. Kamaldeep Sharma 3. Mr. Anubhav Sethi
7.	Action plan for implementing EMP and environmental conditions along with responsibility matrix of the company shall be prepared and shall be duly approved by competent authority. The year wise funds earmarked for environmental protection measures shall be kept in separate account and not to be diverted for any other purpose. Year wise progress of implementation of action plan shall be reported to the Ministry/ Regional Office along with the Six Monthly Compliance Report.	Agreed. The action plan for implementing EMP and the responsibility matrix of the company will be approved by competent authority. Year wise progress of implementation of action plan will be reported to the Ministry/Regional office along with six monthly compliance report.
8.	The project proponent shall submit the environmental statement for each financial year in Form-V to the concerned State Pollution Control Board as prescribed as under the environment (protection) Rule, 1986 as amended subsequently and put on the website of the company.	Noted. Form V for financial year 2022-2023 has been submitted to PPCB as prescribed under environment protection rule, 1986 and same is put up on the website of the company. Receiving of submission of Form –V and Screenshot showing uploaded Form-V on company's website is attached as Annexure-13 .
9.	The project proponent shall inform the Regional Office as well as the Ministry, the date of financial closure and final approval of the project by the concerned authorities, commencing the land development work and start of production operation by the project.	The same is being submitted in the datasheet which is submitted along with compliance report. Also, the regional office as well as the Ministry will be informed regarding the date of financial closure and final approval of the project by concerned authorities.
10.	The project authorities must strictly adhere to the stipulations made by the State Pollution Control Board and the State Government.	Agreed. Stipulations made by the State Pollution Control Board and the State Government will be strictly followed.
11.	The project proponent shall abide by all the commitments and recommendations made in the EIA/EMP report, commitment made during Public Hearing and also that during their presentation to the Expert Appraisal Committee.	Agreed. Commitments made will be followed.

12.	No further expansion or modifications in the plant shall be carried out without prior approval of the Ministry of Environment, Forest and Climate Change (MoEF&CC).	An application has been filed to SEIAA for expansion in Environmental Clearance, Punjab vide SIA/PB/INFRA2/438919/2023 dated 08.09.2023. Screenshot showing the same is shown as Annexure-15 .
13.	Concealing factual data or submission of false/ fabricated data may result in revocation of this environmental clearance and attract action under the provisions of Environment (Protection) Act, 1986.	Noted and agreed.
14.	The Ministry may revoke or suspend the clearance, if implementation of any of the above conditions is not satisfactory.	Noted and agreed.
15.	The Ministry reserves the right to stipulate additional conditions if found necessary. The Company in a time bound manner shall implement these conditions.	Noted and agreed.
16.	The Regional Office of this Ministry shall monitor compliance of the stipulated conditions. The project authorities should extend full cooperation to the officer (s) of the Regional Office by furnishing the requisite data / information/ monitoring reports.	Full cooperation is being extended to the officer of the Regional Office and PPCB by furnishing the requisite data/ information/ monitoring reports.
17.	The above conditions shall be enforced, inter-alia under the provisions of the Water (Prevention & Control of Pollution) Act, 1974, the Air (Prevention & Control of Pollution) Act, 1981, the Environment (Protection) Act, 1986, Hazardous and Other Wastes (Management and Transboundary Movement) Rules, 2016, and the Public Liability Insurance Act, 1991 along with their amendments and Rules and any other orders passed by the Hon'ble Supreme Court of India / High Courts and any other Court of Law relating to the subject matter.	Noted and agreed.
18.	Any appeal against this EC shall lie with the National Green Tribunal, if preferred, within a period of 30 days as prescribed under Section 16 of the National Green Tribunal Act, 2010.	No appeal has been raised against this EC in the National Green Tribunal within a period of 30 days as prescribed under Section 16 of the NGT Act, 2010.

F. No. 21-110/2020-IA-III
Government of India
Ministry of Environment, Forest and Climate Change
(IA.III Section)

Indira Paryavaran Bhawan,
Jor Bagh Road, New Delhi – 3
Tel: 011-24695301 Email: lk.bokolia@nic.in

Date: 23rd February, 2021

To,

Director

M/s S.A. Global Pvt. Ltd.

Unit No. 14, Plot No. 31,
Lower Ground Floor, Road No. 44,
Vikas Tower Building, Rani Bagh,
Community Center, Pitampura, New Delhi,
Saraswati Vihar, North West Delhi-110034
Email: homelandresidences123@gmail.com

Subject: Environmental Clearance for Development of Group Housing Project namely "Homeland Residences" with built-up area of 1,00,287.509 sqm at Sector 77 (opposite Gurudwara Mata Sundar Kaur), Distt. SAS Nagar (Mohali), Punjab by M/s S.A. Global Pvt. Ltd.-regarding.

Sir,

This has reference to your Application/ Proposal No. IA/PB/MIS/189419/2020; received on 23rd December, 2020 through Parivesh Portal for grant of Environmental Clearance (EC) Environmental Clearance for Development of Group Housing Project namely "Homeland Residences" with built-up area of 1,00,287.509 sqm at Sector 77 (opposite Gurudwara Mata Sundar Kaur), Distt. SAS Nagar (Mohali), Punjab, by M/s S.A. Global Pvt. Ltd.

2. As per the provisions of the Environment Impact Assessment (EIA) Notification, 2006; as amended and notified under the Environment (Protection) Act, 1986 (29 of 1986), the above-mentioned project/activity is covered under category 'B' of item 8(a) 'Building and Construction Projects' of the Schedule to the EIA Notification, 2006 and its subsequent amendments, and requires appraisal at State level. However, due to absence of SEIAA/SEAC in Punjab, the proposal required appraisal at Central level by sectoral EAC.

3. Accordingly, the above mentioned proposal for grant of Environmental Clearance has been examined by the Expert Appraisal Committee (Infra-2) its 59th meeting held on 8th January, 2021.

4. The details of the project, as per the Application and documents submitted by the project proponent, and also as informed during the above-mentioned

meetings of EAC (Infra-2) are as under: -

- i. The project is located at Sector 77 (opposite Gurudwara Mata Sundar Kaur), Distt. SAS Nagar (Mohali), Punjab with the coordinates - 30°41'47.96"N Latitude and 76°42'19.16"E Longitude.
- ii. The project is new. The details of building are as follows:

S. No.	Tower details	Store y	Ground coverage (in sq.m.)	FAR (in sq.m.)	Non-FAR except Balcony (in sq.m.)	Service FAR (in sq.m.)	No. of Dwelling units
1.	Tower T1	S+24	755	9,008.005	533.110	1,182.379	48
2.	Tower T2	S+24	755	9,008.004	533.110	1,182.379	48
3.	Tower T3	S+23	755	8,639.942	533.110	1,182.379	69
4.	Tower T4	S+23	755	8,639.942	533.110	1,182.379	46
5.	Tower T5	S+23	755	8,639.942	533.110	1,182.379	46
6.	Tower T6	S+23	755	8,639.943	533.110	1,182.379	46
7.	Booth Site	B+G	725	8,39.916	399.767	131.385	18 shops
8.	Guard Room (2 Nos.)	G	-	-	-	18	-
9.	Basement - 1 Area	-	-	-	14,055.020	-	-
10.	Basement - 2 Area	-	-	-	15,284.850	-	-
Total		-	5,255	53,415.69	32,938.29	7,243.65	303 DU + 18 Shops

- iii. The total plot area is 18,536.082 sqm., FSI area is 53,415.692 sqm and total proposed construction (Built-up) area of project is 1,00,287.509 sqm. The project will comprise of six (06) residential towers (303 residential flats) and 18 shops. Maximum height of building will be 60 m.
- iv. During construction phase, total water requirement is expected to be 14 KLD; which will be met by treated water from STP of PP's existing project situated opposite to this proposed project; namely, Homeland Heights. During the construction phase, septic tanks will be provided for disposal of waste water. Temporary sanitary toilets will be provided during peak labor force.
- v. During operational phase, total water requirement of project is expected to be 122 KLD and same will be met by 92 KLD of fresh water from Greater Mohali Area Development Authority (GMADA) supply and 30 KLD of recycled water. Wastewater generated (98 KLD) will be treated

in a STP of capacity 150 KLD. 46 KLD of treated wastewater will be recycled and re-used for flushing (30 KLD) and gardening (16 KLD). About 50 KLD will be disposed to GMADA sewer / nearby construction activities / water body within the project.

- vi. About 0.58 TPD of solid waste will be generated in the project. The biodegradable waste (0.26 TPD) will be processed in one Mechanical Composter of 300 kg and the non-biodegradable waste and domestic hazardous waste generated (0.32 TPD) will be handed over to authorized local vendor.
- vii. The total power requirement during construction phase and operation phase will be 99 KW and 2089 KW respectively. It will be met from Punjab State Power Corporation Limited (PSPCL).
- viii. Five rain water recharging pits have been proposed.
- ix. Green area proposed will be 2,855.16 sqm. 240 trees are to be planted. Transplantation of two trees is required and these are proposed to be transplanted within the premises only.
- x. Parking facility for 703 ECS is proposed against the requirement of 694 ECS (according to local norms).
- xi. Proposed energy saving measures would save about 13.56% of power.
- xii. The project is not located in Critically Polluted area.
- xiii. The project is situated at a distance of approx. 8 km from City Bird Sanctuary. However, the project is located outside the eco-sensitive zone of the sanctuary as notified in final notification dated 4th January, 2017. Therefore, NBWL Clearance is not required as project is located outside eco-sensitive zone of the City Bird Sanctuary.
- xiv. Forest Clearance is not required.
- xv. No Court case is pending against the project.
- xvi. No activity on the project site has since been taken up.
- xvii. Expected timeline for completion of the project: December, 2024.
- xviii. Investment/Cost of the project is Rs 300 Crores.
- xix. Employment potential: 100 persons during construction phase and 100 persons during operation phase.
- xx. Benefits of the project: Providing comfortable and luxurious living facility along with beautifully designed green spaces and commercial space having 18 shops.

5. The EAC, based on information and clarifications provided by the project proponent and detailed discussions held on the issues, has recommended granting environmental clearance to the project. The aforesaid recommendation of EAC (Infra-2) is subject to certain specific conditions, as stipulated during its 59th meeting held on 8th January, 2021 and the standard EC Conditions as specified by the Ministry vide OM dated 04.01.2019 for the said project/activity.

6. Based on recommendations of EAC (Infra-2), the Ministry of Environment, Forest and Climate Change hereby accords Environmental Clearance to the project for 'Environmental Clearance for Development of Group Housing Project namely "Homeland Residences" with built-up area of 1,00,287.509 sqm at Sector 77 (opposite Gurudwara Mata Sundar Kaur), Distt. SAS Nagar (Mohali), Punjab by M/s S.A. Global Pvt. Ltd.', under the provisions of the EIA

Notification, 2006 and amendments/circulars issued thereon, and subject to the following specific and standard conditions:

A. Specific Conditions:

- i. Explore the possibility of 100% utilization of excess of treated water. The PP should consider diverting the excess treated water for use in nearby construction sites. The PP should approach GMADA for the purpose.
- ii. PP should explore enhancing energy conservation up to at least 5%.
- iii. As committed, no groundwater abstraction shall be done during construction as well as operation phase of the project.
- iv. Fresh water requirement from local authority shall not exceed 92 KLD during operational phase.
- v. Trees cutting/ transplantation shall be subject to prior permission from the concerned local Authority. Compensatory plantation in the ratio of 1:10 (i.e., planting of 10 trees for every 1 tree that is cut) shall be done and maintained. Plantations to be ensured species (cut) to species (planted).
- vi. Area for greenery shall be provided as per the details provided in the project document i.e., area under plantation/greenery will be 2,855.16 sqm. As proposed, at least 240 trees to be maintained during the operation phase of the project. The landscape planning should include plantation of native species. A minimum of 01 tree for every 80 sqm of land should be planted and maintained. The existing trees will be counted for this purpose. Plantations to be ensured species (cut) to species (planted). The species with heavy foliage, broad leaves and wide canopy cover are desirable. Water intensive and/or invasive species should not be used for landscaping.
- vii. As proposed, waste water shall be treated in an onsite STP of total 150 KLD capacity. The treated water from the STP shall be recycled and re-used for flushing (at least 30 KLD) and for gardening (at least 16 KLD).
- viii. The project proponents would commission a third-party study on the implementation of conditions related to quality and quantity of recycle and reuse of treated water, efficiency of treatment systems, quality of treated water being supplied for flushing (specially the bacterial counts), comparative bacteriological studies from toilet seats using recycled treated waters and fresh waters for flushing, and quality of water being supplied through spray faucets attached to toilet seats.
- ix. The local bye-law provisions on rain water harvesting should be followed. If local bye-law provision is not available, adequate provision for storage and recharge should be followed as per the Ministry of Urban Development Model Building Byelaws, 2016. As proposed, five RWH pits shall be provided for rain water harvesting after filtration.
- x. The solid waste shall be duly segregated into biodegradable and non-biodegradable components and handled in separate area earmarked for segregation of solid waste. As committed, biodegradable waste shall be composted by use of Composter. Inert waste shall be dumped to authorized site. The recyclable waste shall be sold to resellers.
- xi. The PP shall also provide electric charging points in the parking areas

- for e-vehicles as committed.
- xii. The Environmental Clearance to the project is primarily under provisions of EIA Notification, 2006. The Project Proponent is under obligation to obtain approvals /clearances under any other Acts/ Regulations or Statutes as applicable to the project.

B. Standard Conditions:

I. Statutory compliance:

- i. The project proponent shall obtain all necessary clearance/ permission from all relevant agencies including town planning authority before commencement of work. All the construction shall be done in accordance with the local building byelaws.
- ii. The approval of the Competent Authority shall be obtained for structural safety of buildings due to earthquakes, adequacy of firefighting equipment etc as per National Building Code including protection measures from lightening etc.
- iii. The project proponent shall obtain forest clearance under the provisions of Forest (Conservation) Act, 1980, in case of the diversion of forest land for non-forest purpose involved in the project.
- iv. The project proponent shall obtain clearance from the National Board for Wildlife, if applicable.
- v. The project proponent shall obtain Consent to Establish / Operate under the provisions of Air (Prevention & Control of Pollution) Act, 1981 and the Water (Prevention & Control of Pollution) Act, 1974 from the concerned State Pollution Control Board/ Committee.
- vi. The project proponent shall obtain the necessary permission for drawl of ground water / surface water required for the project from the competent authority.
- vii. A certificate of adequacy of available power from the agency supplying power to the project along with the load allowed for the project should be obtained.
- viii. All other statutory clearances such as the approvals for storage of diesel from Chief Controller of Explosives, Fire Department, Civil Aviation Department shall be obtained, as applicable, by project proponents from the respective competent authorities.
- ix. The provisions of the Solid Waste Management Rules, 2016, e-Waste (Management) Rules, 2016, and the Plastics Waste Management Rules, 2016, shall be followed.
- x. The project proponent shall follow the ECBC/ECBC-R prescribed by Bureau of Energy Efficiency, Ministry of Power strictly.

II. Air quality monitoring and preservation:

- i. Notification GSR 94(E) dated 25.01.2018 of MoEF&CC regarding Mandatory Implementation of Dust Mitigation Measures for Construction and Demolition Activities for projects requiring Environmental Clearance shall be complied with.

- ii. A management plan shall be drawn up and implemented to contain the current exceedance in ambient air quality at the site.
- iii. The project proponent shall install system to carryout Ambient Air Quality monitoring for common/criterion parameters relevant to the main pollutants released (e.g. PM₁₀ and PM_{2.5}) covering upwind and downwind directions during the construction period.
- iv. Diesel power generating sets proposed as source of backup power should be of enclosed type and conform to rules made under the Environment (Protection) Act, 1986. The height of stack of DG sets should be equal to the height needed for the combined capacity of all proposed DG sets. Use of low sulphur diesel. The location of the DG sets may be decided with in consultation with State Pollution Control Board.
- v. Construction site shall be adequately barricaded before the construction begins. Dust, smoke & other air pollution prevention measures shall be provided for the building as well as the site. These measures shall include screens for the building under construction, continuous dust/ wind breaking walls all around the site (at least 3 meter height). Plastic/tarpaulin sheet covers shall be provided for vehicles bringing in sand, cement, murram and other construction materials prone to causing dust pollution at the site as well as taking out debris from the site.
- vi. Sand, murram, loose soil, cement, stored on site shall be covered adequately so as to prevent dust pollution.
- vii. Wet jet shall be provided for grinding and stone cutting.
- viii. Unpaved surfaces and loose soil shall be adequately sprinkled with water to suppress dust.
- ix. All construction and demolition debris shall be stored at the site (and not dumped on the roads or open spaces outside) before they are properly disposed. All demolition and construction waste shall be managed as per the provisions of the Construction and Demolition Waste Management Rules 2016.
- x. The diesel generator sets to be used during construction phase shall be low sulphur diesel type and shall conform to Environmental (Protection) prescribed for air and noise emission standards.
- xi. The gaseous emissions from DG set shall be dispersed through adequate stack height as per CPCB standards. Acoustic enclosure shall be provided to the DG sets to mitigate the noise pollution. Low sulphur diesel shall be used. The location of the DG set and exhaust pipe height shall be as per the provisions of the Central Pollution Control Board (CPCB) norms.
- xii. For indoor air quality the ventilation provisions as per National Building Code of India.

III. Water quality monitoring and preservation:

- i. The natural drain system should be maintained for ensuring unrestricted flow of water. No construction shall be allowed to obstruct the natural drainage through the site, on wetland and water bodies. Check dams, bio-swales, landscape, and other sustainable urban

- drainage systems (SUDS) are allowed for maintaining the drainage pattern and to harvest rain water.
- ii. Buildings shall be designed to follow the natural topography as much as possible. Minimum cutting and filling should be done.
 - iii. Total fresh water use shall not exceed the proposed requirement as provided in the project details.
 - iv. The quantity of fresh water usage, water recycling and rainwater harvesting shall be measured and recorded to monitor the water balance as projected by the project proponent. The record shall be submitted to the Regional Office, MoEF&CC along with six monthly Monitoring reports.
 - v. A certificate shall be obtained from the local body supplying water, specifying the total annual water availability with the local authority, the quantity of water already committed, the quantity of water allotted to the project under consideration and the balance water available. This should be specified separately for ground water and surface water sources, ensuring that there is no impact on other users.
 - vi. At least 20% of the open spaces as required by the local building bye-laws shall be pervious. Use of Grass pavers, paver blocks with at least 50% opening, landscape etc. would be considered as pervious surface.
 - vii. Installation of dual pipe plumbing for supplying fresh water for drinking, cooking and bathing etc and other for supply of recycled water for flushing, landscape irrigation, car washing, thermal cooling, conditioning etc. shall be done.
 - viii. Use of water saving devices/ fixtures (viz. low flow flushing systems; use of low flow faucets tap aerators etc) for water conservation shall be incorporated in the building plan.
 - ix. Separation of grey and black water should be done by the use of dual plumbing system. In case of single stack system separate recirculation lines for flushing by giving dual plumbing system be done.
 - x. Water demand during construction should be reduced by use of pre-mixed concrete, curing agents and other best practices referred.
 - xi. The local bye-law provisions on rain water harvesting should be followed. If local bye-law provision is not available, adequate provision for storage and recharge should be followed as per the Ministry of Urban Development Model Building Byelaws, 2016. Rain water harvesting recharge pits/storage tanks shall be provided for ground water recharging as per the CGWB norms.
 - xii. A rain water harvesting plan needs to be designed where the recharge bores of minimum one recharge bore per 5,000 square meters of built up area and storage capacity of minimum one day of total fresh water requirement shall be provided. In areas where ground water recharge is not feasible, the rain water should be harvested and stored for reuse. The ground water shall not be withdrawn without approval from the Competent Authority.
 - xiii. All recharge should be limited to shallow aquifer.
 - xiv. No ground water shall be used during construction phase of the project.
 - xv. Any ground water dewatering should be properly managed and shall conform to the approvals and the guidelines of the CGWA in the matter.

- Formal approval shall be taken from the CGWA for any ground water abstraction or dewatering.
- xvi. The quantity of fresh water usage, water recycling and rainwater harvesting shall be measured and recorded to monitor the water balance as projected by the project proponent. The record shall be submitted to the Regional Office, MoEF&CC along with six monthly Monitoring reports.
 - xvii. Sewage shall be treated in the STP with tertiary treatment. The treated effluent from STP shall be recycled/re-used for flushing, AC make up water and gardening. As proposed, no treated water shall be disposed in to municipal drain.
 - xviii. No sewage or untreated effluent water would be discharged through storm water drains.
 - xix. Onsite sewage treatment of capacity of treating 100% waste water to be installed. The installation of the Sewage Treatment Plant (STP) shall be certified by an independent expert and a report in this regard shall be submitted to the Ministry before the project is commissioned for operation. Treated waste water shall be reused on site for landscape, flushing, cooling tower, and other end-uses. Excess treated water shall be discharged as per statutory norms notified by Ministry of Environment, Forest and Climate Change. Natural treatment systems shall be promoted.
 - xx. Periodical monitoring of water quality of treated sewage shall be conducted. Necessary measures should be made to mitigate the odour problem from STP.
 - xxi. Sludge from the onsite sewage treatment, including septic tanks, shall be collected, conveyed and disposed as per the Ministry of Urban Development, Central Public Health and Environmental Engineering Organization (CPHEEO) Manual on Sewerage and Sewage Treatment Systems, 2013.

IV. Noise monitoring and prevention:

- i. Ambient noise levels shall conform to residential area/commercial area/industrial area/silence zone both during day and night as per Noise Pollution (Control and Regulation) Rules, 2000. Incremental pollution loads on the ambient air and noise quality shall be closely monitored during construction phase. Adequate measures shall be made to reduce ambient air and noise level during construction phase, so as to conform to the stipulated standards by CPCB / SPCB.
- ii. Noise level survey shall be carried as per the prescribed guidelines and report in this regard shall be submitted to Regional Officer of the Ministry as a part of six-monthly compliance report.
- iii. Acoustic enclosures for DG sets, noise barriers for ground-run bays, ear plugs for operating personnel shall be implemented as mitigation measures for noise impact due to ground sources.

227

V. Energy Conservation measures:

- i. Compliance with the Energy Conservation Building Code (ECBC) of Bureau of Energy Efficiency shall be ensured. Buildings in the States which have notified their own ECBC, shall comply with the State ECBC.
- ii. Outdoor and common area lighting shall be LED.
- iii. Concept of passive solar design that minimize energy consumption in buildings by using design elements, such as building orientation, landscaping, efficient building envelope, appropriate fenestration, increased day lighting design and thermal mass etc. shall be incorporated in the building design. Wall, window, and roof u-values shall be as per ECBC specifications.
- iv. Energy conservation measures like installation of CFLs/ LED for the lighting the area outside the building should be integral part of the project design and should be in place before project commissioning.
- v. Solar, wind or other Renewable Energy shall be installed to meet electricity generation equivalent to 1% of the demand load or as per the state level/ local building bye-laws requirement, whichever is higher.
- vi. Solar power shall be used for lighting in the apartment to reduce the power load on grid. Separate electric meter shall be installed for solar power. Solar water heating shall be provided to meet 20% of the hot water demand of the commercial and institutional building or as per the requirement of the local building bye-laws, whichever is higher. Residential buildings are also recommended to meet its hot water demand from solar water heaters, as far as possible.

VI. Waste Management:

- i. A certificate from the competent authority handling municipal solid wastes, indicating the existing civic capacities of handling and their adequacy to cater to the M.S.W. generated from project shall be obtained.
- ii. Disposal of muck during construction phase shall not create any adverse effect on the neighbouring communities and be disposed taking the necessary precautions for general safety and health aspects of people, only in approved sites with the approval of competent authority.
- iii. Separate wet and dry bins must be provided in each unit and at the ground level for facilitating segregation of waste. Solid waste shall be segregated into wet garbage and inert materials.
- iv. Organic waste compost/ Vermiculture pit/ Organic Waste Converter within the premises with a minimum capacity of 0.3 kg /person/day must be installed.
- v. All non-biodegradable waste shall be handed over to authorized recyclers for which a written tie up must be done with the authorized recyclers.
- vi. Any hazardous waste generated during construction phase, shall be disposed off as per applicable rules and norms with necessary approvals of the State Pollution Control Board.
- vii. Use of environment friendly materials in bricks, blocks and other construction materials, shall be required for at least 20% of the construction material quantity. These include Fly Ash bricks, hollow

- bricks, AACs, Fly Ash Lime Gypsum blocks, Compressed earth blocks, and other environment friendly materials.
- viii. Fly ash should be used as building material in the construction as per the provision of Fly Ash Notification of September, 1999 and amended as on 27th August, 2003 and 25th January, 2016. Ready mixed concrete must be used in building construction.
 - ix. Any wastes from construction and demolition activities related thereto shall be managed so as to strictly conform to the Construction and Demolition Waste Management Rules, 2016.
 - x. Used CFLs and TFLs should be properly collected and disposed off/sent for recycling as per the prevailing guidelines/ rules of the regulatory authority to avoid mercury contamination.

VII. Green Cover:

- i. No tree can be felled/transplant unless exigencies demand. Where absolutely necessary, tree felling shall be with prior permission from the concerned regulatory authority. Old trees should be retained based on girth and age regulations as may be prescribed by the Forest Department. Plantations to be ensured species (cut) to species (planted).
- ii. Topsoil should be stripped to a depth of 20 cm from the areas proposed for buildings, roads, paved areas, and external services. It should be stockpiled appropriately in designated areas and reapplied during plantation of the proposed vegetation on site.

VIII. Transport

- i. A comprehensive mobility plan, as per MoUD best practices guidelines (URDPFI), shall be prepared to include motorized, non-motorized, public, and private networks. Road should be designed with due consideration for environment, and safety of users. The road system can be designed with these basic criteria.
 - a. Hierarchy of roads with proper segregation of vehicular and pedestrian traffic.
 - b. Traffic calming measures.
 - c. Proper design of entry and exit points.
 - d. Parking norms as per local regulation.
- ii. Vehicles hired for bringing construction material to the site should be in good condition and should have a pollution check certificate and should conform to applicable air and noise emission standards be operated only during non-peak hours.
- iii. A detailed traffic management and traffic decongestion plan shall be drawn up to ensure that the current level of service of the roads within a 05 kms radius of the project is maintained and improved upon after the implementation of the project. This plan should be based on cumulative impact of all development and increased habitation being carried out or proposed to be carried out by the project or other agencies in this 05 Kms radius of the site in different scenarios of space and time and the traffic management plan shall be duly validated and certified

by the State Urban Development department and the P.W.D./ competent authority for road augmentation and shall also have their consent to the implementation of components of the plan which involve the participation of these departments.

IX. Human health issues:

- i. All workers working at the construction site and involved in loading, unloading, carriage of construction material and construction debris or working in any area with dust pollution shall be provided with dust mask.
- ii. For indoor air quality the ventilation provisions as per National Building Code of India.
- iii. Emergency preparedness plan based on the Hazard identification and Risk Assessment (HIRA) and Disaster Management Plan shall be implemented.
- iv. Provision shall be made for the housing of construction labour within the site with all necessary infrastructure and facilities such as fuel for cooking, mobile toilets, mobile STP, safe drinking water, medical health care, crèche etc. The housing may be in the form of temporary structures to be removed after the completion of the project.
- v. Occupational health surveillance of the workers shall be done on a regular basis.
- vi. A First Aid Room shall be provided in the project both during construction and operations of the project.

X. Miscellaneous:

- i. The project proponent shall prominently advertise it at least in two local newspapers of the District or State, of which one shall be in the vernacular language within seven days indicating that the project has been accorded environment clearance and the details of MoEFCC/SEIAA website where it is displayed.
- ii. The copies of the environmental clearance shall be submitted by the project proponents to the Heads of local bodies, Panchayats and Municipal Bodies in addition to the relevant offices of the Government who in turn has to display the same for 30 days from the date of receipt.
- iii. The project proponent shall upload the status of compliance of the stipulated environment clearance conditions, including results of monitored data on their website and update the same on half-yearly basis.
- iv. The project proponent shall submit six-monthly reports on the status of the compliance of the stipulated environmental conditions on the website of the ministry of Environment, Forest and Climate Change at environment clearance portal.
- v. The company shall have a well laid down environmental policy duly approved by the Board of Directors. The environmental policy should prescribe for standard operating procedures to have proper checks and balances and to bring into focus any infringements/deviation/violation of the environmental / forest / wildlife norms / conditions. The

- company shall have defined system of reporting infringements / deviation / violation of the environmental / forest / wildlife norms / conditions and / or shareholders / stake holders. The copy of the board resolution in this regard shall be submitted to the MoEF&CC as a part of six-monthly report.
- vi. A separate Environmental Cell both at the project and company head quarter level, with qualified personnel shall be set up under the control of senior Executive, who will directly report to the head of the organization.
 - vii. Action plan for implementing EMP and environmental conditions along with responsibility matrix of the company shall be prepared and shall be duly approved by competent authority. The year wise funds earmarked for environmental protection measures shall be kept in separate account and not to be diverted for any other purpose. Year wise progress of implementation of action plan shall be reported to the Ministry/Regional Office along with the Six Monthly Compliance Report
 - viii. The project proponent shall submit the environmental statement for each financial year in Form-V to the concerned State Pollution Control Board as prescribed under the Environment (Protection) Rules, 1986, as amended subsequently and put on the website of the company.
 - ix. The project proponent shall inform the Regional Office as well as the Ministry, the date of financial closure and final approval of the project by the concerned authorities, commencing the land development work and start of production operation by the project.
 - x. The project authorities must strictly adhere to the stipulations made by the State Pollution Control Board and the State Government.
 - xi. The project proponent shall abide by all the commitments and recommendations made in the EIA/EMP report, commitment made during Public Hearing and also that during their presentation to the Expert Appraisal Committee.
 - xii. No further expansion or modifications in the plant shall be carried out without prior approval of the Ministry of Environment, Forest and Climate Change (MoEF&CC).
 - xiii. Concealing factual data or submission of false/fabricated data may result in revocation of this environmental clearance and attract action under the provisions of Environment (Protection) Act, 1986.
 - xiv. The Ministry may revoke or suspend the clearance, if implementation of any of the above conditions is not satisfactory.
 - xv. The Ministry reserves the right to stipulate additional conditions if found necessary. The Company in a time bound manner shall implement these conditions.
 - xvi. The Regional Office of this Ministry shall monitor compliance of the stipulated conditions. The project authorities should extend full cooperation to the officer (s) of the Regional Office by furnishing the requisite data / information/monitoring reports.
 - xvii. The above conditions shall be enforced, inter-alia under the provisions of the Water (Prevention & Control of Pollution) Act, 1974, the Air (Prevention & Control of Pollution) Act, 1981, the Environment (Protection) Act, 1986, Hazardous and Other Wastes (Management and Transboundary Movement) Rules, 2016, and the Public Liability

- Insurance Act, 1991 along with their amendments and Rules and any other orders passed by the Hon'ble Supreme Court of India / High Courts and any other Court of Law relating to the subject matter.
- xviii. Any appeal against this EC shall lie with the National Green Tribunal, if preferred, within a period of 30 days as prescribed under Section 16 of the National Green Tribunal Act, 2010.

7. The Environmental Clearance is being granted to M/s. S.A. Global Pvt. Ltd for Development of Group Housing Project namely "Homeland Residences" with built-up area of 1,00,287.509 sqm at Sector 77 (opposite Gurudwara Mata Sundar Kaur), Distt. SAS Nagar (Mohali), Punjab

8. This issues with the approval of the Competent Authority.

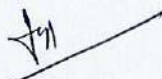
(Lalit Bokolia)
Director(S)

Copy to:

1. Secretary, Department of Science & Technology and Environment, Government of Punjab, Punjab Civil Secretariat-2, 9A, Sector-9, Chandigarh-160009
2. Regional Officer, Ministry of Environment, Forest and Climate Change, Integrated Regional Office (Northern Zone), Bays No. 24-25, Sector 31 A, Dakshin Marg, Chandigarh - 160030
3. Chairman, Central Pollution Control Board Parivesh Bhavan, CBD-cum-Office Complex, East Arjun Nagar, New Delhi - 110 032.
4. Member Secretary, Punjab Pollution Control Board, Vatavaran Bhawan, Nabha Road, Patiala- 147001, Punjab
5. Monitoring Cell, MoEF&CC, Indira Paryavaran Bhavan, New Delhi.
6. Guard File/ Record File/ Notice Board/MoEF&CC website.

(Lalit Bokolia)
Director(S)

CONSTRUCTION STATUS

Tower No.	Units (in no.)	Status of Work
Basement (upper and lower)	2 no.	Completed
Tower-1 (S+ 21)	39	Stilt column in progress
Tower-2 (S+ 21)	40	Stilt column in progress
Tower-3 (S+ 24)	68	Completed Till 2nd Floor
Tower-4 (S+ 24)	44	Completed till 9th Floor
Tower-5 (S+ 24)	44	Completed till 9th Floor
Tower-6 (S+ 24)	44	Completed till 4th Floor
Total Flats	279 Flats	
Commercial	23 no.	Construction in initial phase
Club House <ul style="list-style-type: none"> • Club -1 (1st and 2nd Floor on Commercial) • Club-2 (stilt of Tower-1) 	2 no.	Yet to be constructed

PROJECT PHOTOGRAPHS



PHOTOGRAPHS OF GREEN AREA WITHIN THE PROJECT SITE





P







PUNJAB WATER REGULATION AND DEVELOPMENT AUTHORITY

SCO 149-152, SECTOR 17, CHANDIGARH – 160017

ad interim PERMISSION FOR EXTRACTION OF GROUNDWATER

Name of Unit	Homeland Regalia (earlier Homeland Residencies)		
Activity of Unit:	Infrastructure		
Address of Unit:	Homeland Regalia (earlier Homeland Residencies) by M/s S.A Global Pvt. Ltd., Sector 77, SAS Nagar	PIN Code: 160055	
Assessment Unit (Block):	Kharar	Category: Yellow	
District:	SAS Nagar		
Correspondence Address:	M/s S. A Global Pvt. Ltd., Homeland Regalia, Sector 77, SAS Nagar	PIN Code: 160055	
Unit ID	0940500231		
Permission Number	PWRDA/08/2021/L2/178	Dated: 02.08.2021	
Project Status:	New Unit		
Permission Type:	<i>ad-interim</i> Permission		
Validity Period:	For a period of three months from the date of publication of the final guidelines by the Authority, or for three years from the date of grant of this <i>ad interim</i> permission, whichever is earlier.		
Ground Water Extraction Permitted: 144 m ³ /day			
Fresh Water		Saline Water	
m ³ /day	m ³ /month*	m ³ /day	m ³ /month*
144	4,320	-	-

*Note:- Month is taken as 30 days for calculation of charges.

Fees and Charges Paid:**A. Application Fees for Groundwater Extraction:**

Volume of Groundwater Extraction Applied For per day (in m ³ /day)	Fees Deposited (in Rs.)
144	16,000/- (20% Covid-19 rebate applied)

B. Advance Deposit equivalent to two months of charges for the permitted quantity of groundwater extraction:

Category of Area	Extraction Permitted: (m ³ /day)	144	Amount Deposited (Rs.)	
Yellow	Charges for two months		1,01,376/- (20% Covid-19 rebate applied)	
	<10 m ³ /day	10-100 m ³ /day		>100 m ³ /day
	3,600	75,600		47,520

C. Tube-well Registration Fee paid:

No. of existing tube-wells	No. of Proposed tube-wells	No. of total tube-wells	Registration Fee applicable per tube-well	Total Registration Fee Paid (Rs.)
Nil	02	02	10,000/-	16,000/- (20% Covid-19 rebate applied)

D. Total Amount Paid (Rs.):

Application Fee	Advance Deposit	Tube-well Registration Fee	Total(Rs.)
16,000/-	1,01,376/-	16,000/-	1,33,376/-

NOTE: This permission is granted in terms of the Draft Punjab Guidelines for Groundwater Extraction and Conservation published on November 12, 2020 under section 15 of the Punjab Water Resources (Regulation and Management) Act 2020 and is subject to the conditions given overleaf.

Dated: 2nd August, 2021
Place: CHANDIGARH



J.P. Singh
02.08.2021

Signature
Jobanpreet Singh, A.O.L-2

ad interim PERMISSION CONDITIONS

- 1) The permission is valid for a period of three months from the date of publication of the final guidelines by the Authority, or for three years from the date of grant of this ad interim permission, whichever is earlier. The unit will apply again for Permission within one month after the publication of the final Guidelines.
- 2) Since, this Permission has been issued on the basis of self-assessment by the applicant and without any site inspection or verification of documents submitted by the applicant, hence the Authority may inspect the unit and documents at any time. In case any material difference is found in the information submitted and the site conditions or documents, the Authority may suspend the permission granted immediately and may revoke or modify the permission after giving a notice to the Unit.
- 3) The unit shall comply with the provisions of the Punjab Water Resources (Management and Regulation) Act, 2020, and the Regulations and Directions issued thereunder.
- 4) A Unit operational prior to 12/11/2020 shall be liable to pay groundwater extraction charges w.e.f. 12th Nov, 2020. A unit which is yet to begin operations shall be liable to pay the charges from the date of commencement of extraction of groundwater.
- 5) The unit shall install a water meter at each of its extraction structures within 60 days of issue of this permission letter (Refer Para 7.1 of the Draft Guidelines.)
- 6) Till the installation of water meter the Unit shall pay the full amount for the entire volume of groundwater permitted.
- 7) The Unit shall self-record the water meter readings in the format set by the Authority on the first working day of every month and submit the same and pay the applicable charges to PWRDA by 10th of every month.
- 8) Units permitted to extract 50m³/day or more groundwater shall communicate water level data to PWRDA in the first week of every month. (Refer para 7.2 of the Draft Guidelines).
- 9) This Permission does not absolve the unit of its obligations to obtain other required statutory and administrative clearances from appropriate authorities.
- 10) The issue of this Permission does not imply that other statutory or administrative clearances shall necessarily be granted to the unit by the concerned authorities.
- 11) This Permission is being issued without any prejudice to the directions of any court of law in cases related to groundwater or any other related matters.
- 12) Water conservation credit claims (if any) will be examined and verified separately.
- 13) In view of the Covid-19 epidemic, the Groundwater Charges in the Draft Guidelines will be reduced by 20% till July 31st, 2021.
- 14) Since, the unit has not paid the GST. Hence, it will be bound to deposit the same within 7 days as and when required by the Authority.

X-----X



BACK TO WEB PORTAL



Gurbhagwant

PERMISSIONS OF GROUNDWATER EXTRACTION

- Registered Units
- Draft
- Submitted**
- Approved
- Rejected
- Returned
- Cancel / Suspension

Show 10 entries

Search:

#	Service Type	Application Number	Application Date	Unit Identification Number	Unit Name	Payment Status	Application Status	Actions
1	Fresh Application	20230400286141	2023-09-16 12:53:35	20230400286	Homeland Regalia (earlier Homeland Residencies)	Done	In Processing	

Showing 1 to 1 of 1 entries

Previous 1 Next

- Dashboard
- Steps To Apply
- Groundwater Extraction ^**
- Register New Unit
- Unit List
- Application List**
- Transfer Unit
- Water Tanker
- Drilling Rig
- Payment History
- Credit History



PUNJAB POLLUTION CONTROL BOARD
Invest Punjab, PBIP, Udyog Bhawan, Sector 17, Chandigarh
Website:- www.ppcb.gov.in



Office Dispatch No.: **PBIP/J/540871/2023**

Date: **10.04.2023**

To

ABHEY JINDAL
PRINTER APARTMENT NEAR BHAGWAT HOSPITAL, SECTOR-13 LONI 0, ROHINI SECTOR-14, NORTH WEST
S.A.S NAGAR, MOHALI - 110085

Subject:- Extension in the Validity of "Consent to Establish"(NOC) Granted u/s 25 of Water (Prevention & Control of Pollution) Act, 1974 and u/s 21 of Air (Prevention & Control of Pollution) Act, 1981 to the Unit.

1. Particulars of Consent to Establish (NOC) granted to the Industry:

PIN	220169784
Application No.:	2301450327
Date of Issue:	10-Apr-2023
Date of Expiry:	27-Feb-2024
Certificate Type:	Fresh
Certificate No:	CTE/Ext/PBIP/SAS/2023/220169784

2. Particulars of the Industry:

Name & Designation of the Applicant:	ABHEY JINDAL, (Director)
Name of Business Entity	M/s SA Global Pvt. Ltd.
Name of the Project/Unit:	Homeland Regalia by M/s SA Global Pvt. Ltd.
Address of Project/Unit:	GROUP HOUSING SITE, Homeland Regalia, SECTOR - 77, MOHALI, SAS Nagar, Punjab, Mohali, S.A.S Nagar
Capital Investment of the Industry(in lakhs):	38858
Category of Industry:	Red
Type of Industry:	1063 - Building and construction projects more than 20,000 sq. m built up area and having waste water generation 100 KLD and above.
Scale of the Industry:	Large - > Rs. 50 Crore
Office District:	SAS Nagar
Consent Fee Details:	Rs. 1,80,500/- vide online R. no. 143275888 dated 22/02/2023.
Raw Materials (Name with quantity per day):	Building construction project having total built up area of 1,33,066.201 sqm and consisting of Residential flats @279Nmbor, Commercial shops @22Nmbor & Club houses @2Nmbor.
Products (Name with quantity per day):	Building construction project having total built up area of 1,33,066.201 sqm and consisting of Residential flats @279Nmbor, Commercial shops @22Nmbor & Club houses @2Nmbor.
By Products, if any (Name	--

with quantity per day) :	
Details of the machinery and processes:	As per application form.
Details of Effluent Treatment Plant:	Domestic Effluent @274.0 KLD - Sewage Treatment Plant (STP) of capacities 300 KLD & 20 KLD.
Mode of disposal of Effluent:	Treated wastewater @ 117 KLD shall be reused for flushing purpose by providing dual plumbing system in the project. Treated wastewater @ 26 KLD is to be used for plantation purpose within its premises in an area of 4671 sqm. Treated wastewater @ 253 KLD (maximum) for construction activities and to be discharged into GMADA sewer.
Standard to be achieved under Water(Prevention & Control of Pollution) Act, 1974:	As prescribed by the CPCB/MoEF&CC/PPCB, from time to time.
Sources of emissions and type of pollutants:	03 no. DG sets of capacities 500 KVA each & 01 no. DG set of capacity 380 KVA - SPM, SOx, NOx
Mode of disposal of emissions with stack height:	03 no. DG sets of capacities 500 KVA each & 01 no. DG set of capacity 380 KVA - canopies alongwith Stack of height as per following formula: $H = h+0.2 (KVA)^{0.5}$ where h = height of the building in meters where the generator set is installed.
Quantity of fuel required in TPD:	03 no. DG sets of capacities 500 KVA each & 01 no. DG set of capacity 380 KVA -HSD as fuel
Type of Air Pollution Control Devices to be installed:	03 no. DG sets of capacities 500 KVA each & 01 no. DG set of capacity 380 KVA - canopies alongwith Stack of height as per following formula: $H = h+0.2 (KVA)^{0.5}$ where h = height of the building in meters where the generator set is installed.
Standard to be achieved under Air(Prevention & Control of Pollution) Act, 1981:	As prescribed by the CPCB/MoEF&CC/PPCB, from time to time.

Environmental Engineer (PBIP)
for & on behalf of
Chief Environmental Engineer (PBIP)

Endst. No.

Dated:

A copy of the above is forwarded to the following for information and necessary action please:

1. Senior Environmental Engineer, Zonal Office-1, Patiala.
2. Environmental Engineer, Regional Office, SAS Nagar

Environmental Engineer (PBIP)
for & on behalf of
Chief Environmental Engineer (PBIP)

B. SPECIAL CONDITIONS

The extension in the validity of the Consent to Establish earlier granted to the project proponent vide no. CTE/Fresh/SAS/2022/18225887 dated 12/05/2022 having validity upto 28/02/2023, for construction of Group Housing Project having total built up area of 1,33,066.201 sqm, for one year i.e. upto 27/02/2024, subject to all terms & conditions as mentioned in the original CTE granted to the project proponent and the following additional conditions that:

1. The project proponent shall obtain revised Environment Clearance from the competent authority for the development of its project with total built-up area of 1,33,066.201 sqm, with components as approved in the layout plan already approved by the competent authority. *mentioned*
2. The project proponent shall not carry out any construction in aberration to the conceptual plan submitted at the time of grant of Environment Clearance to it (i.e. with total built-up area of 1,00,287.509 sqm), to refrain from committing violation & action thereof under the Environment (Protection) Act, 1986.
3. After obtaining revised Environment Clearance as mentioned above, the promoter shall develop its project strictly in accordance with the layout plans approved by the Competent Authority.
4. In case, there is any deviation in the details/particulars mentioned in this Consent letter and in the revised Environmental Clearance to be obtained by the project proponent under the EIA notification dated 14.09.2006, the project proponent shall be bound to obtain fresh CTE from PPCB.

-sl-

Environmental Engineer (PBIP)
for & on behalf of
Chief Environmental Engineer (PBIP)

Tele: 011-25687194/7315

HQ Western Air Command,
Indian Air Force
Subroto Park
New Delhi-10

WAC/S 5016/2/ATS (48/23)

21 June 2023

M/s Homeland Regalia,
Allotment Number – 5469,
Group housing site,
Near Radha Swami Satsang Bhawan,
200 Ft Airport Road, Sector – 77,
Mohali, District – SAS Nagar,
Punjab – 160070,
Ph: 9855978222

NOC FOR CONSTRUCTION OF BUILDING

Sir,

1. Please refer your application dated 03 May 2023 on the subject, received at this HQ on 16 May 2023.

2. The application has been examined under Gazette of India GSR 751 (E), Works of Defence Act 1903 and other relevant orders on the subject. This HQ has no objection for construction of 91 m high building for group housing project named "Homeland Regalia" at Allotment No. 5469, group housing site near Radha Swami Satsang Bhawan, 200 Ft Airport road, Sector – 77, Mohali, district – SAS Nagar, Punjab, subject to following conditions: -

(a) The NOC with respect to Air Force Station Chandigarh is for construction of the subject building and cannot be used as document for any other purpose/ claim whatsoever including ownership of land.

(b) The applicant is responsible to obtain NOC/all statutory clearance from the concerned authorities including approval of building plans. Clearance shall also be obtained separately from any other defence establishment in the vicinity of proposed construction.

(c) The site elevation and site coordinates provided by the applicant are taken for calculation of the permissible top elevation of the proposed structure. However, at any stage, if it is established that the actual site elevation and site coordinates are different from those provided by the applicant, the NOC will be invalid.

(d) The issue of the NOC is further subject to the provisions of Section 5(2) of GSR 751 (E) read in conjunction with sub section (1) and clause (O) & clause (R) of sub section 2 of section 5 read with section 9 (A) of Aircraft Act 1934.

(e) Vertical extent (highest point) of the building proposed at coordinates mentioned below shall not exceed 405 m AMSL or 91 m AGL. No extension or structure permanent or temporary (e.g. Cranes, Antennas,



Mumtee, lightening Arresters, Lift machine room, Overhead water tank, Cooling towers, Sign boards, any attachment or fixtures of any kind) shall be permitted above the cleared height.

Corners	Latitude	Longitude	Site Elevation
1	30°41' 47" N	76°42' 18" E	313 m, AMSL
2	30°41' 43" N	76°42' 21" E	313 m, AMSL
3	30°41' 45" N	76°42' 25" E	314 m, AMSL
4	30°41' 48" N	76°42' 23" E	314 m, AMSL
5	30°41' 48" N	76°42' 20" E	314 m, AMSL

(f) Standard obstruction lightings as per International Civil Aviation Organization (ICAO) standards, as stipulated in ICAO Annex-14, is to be provided by the company. The lights shall be kept 'ON' at all times. Provision shall be made for standby power supply to keep the lights 'ON' during power failure. Company shall carry out periodic maintenance of the lights to keep them in serviceable and visible condition.

(g) A proper garbage disposal system in accordance with the provisions of Solid Waste Management Rule, 2016 / Gazette Notification SO 1357 (E) (Para 4) or Environment (Protection) Act, 1986 including amendments shall be adhered to by the applicant for the purpose of avoiding bird activity.

(h) No light or a combination of lights which by reason of its intensity, configuration or colour may cause confusion with the aeronautical ground lights of the airport shall be installed at the site at any time during or after the construction of the building.

(j) The commencement and completion of construction including installation of obstruction lights shall be intimated to Air Officer Commanding, AF Station Chandigarh. Failure to render these certificates within the stipulated time shall lead to cancellation of NOC.

(k) The NOC is valid for **Five years** from the date of its issue. If the building is not constructed and completed within this period, the applicant shall be required to obtain a fresh NOC from Indian Air Force.

Yours sincerely,



(S Santhosh)
Group Captain
Command ATC Officer

Copy to:

Air HQ (VB) (Wg Cdr Ops ATS-IV)

AF Stn Chandigarh (SATCO)

Internal:

C Nav O



Eco Paryavaran Laboratories & Consultants Pvt. Ltd.

(Formerly known as Eco Laboratories & Consultants Pvt. Ltd.)

TEST REPORT

ULR No. : NA		Test Report No. : GWAM180723GE025	
Type of Sample : Water (Ground Water)		Date of Reporting : 21/07/2023	
Customer	Group Housing Project "Homeland Regalia" By M/s S.A.Global Pvt.Ltd. Sector-77,SAS Nagar Mohali, Punjab	Work Order No. & Date	Work Order Dt.: 28/06/2023
		Customer reference No. (If any)	NA
Sampling Protocol	IS:17614 (P-1) 2021	Mode of Collection of Sample	Sampling by laboratory
Date of Sampling	18/07/2023	Date of Receipt of Sample	18/07/2023
Sampling Location	Borewell at Naggar Kheda Sec-76, Mohali	Testing Location	Permanent Facility
Testing Protocol	IS:10500-2012 (IInd Revision)	Period of Analysis	18/07/2023 To 21/07/2023
Sample Description	Colourless liquid.		
Packing, Markings, Seal & Qty.	2 litre Plastic & 500ml Glass Bottle Marked H/18/02		

RESULTS

I-Chemical Testing

1. Water (Ground Water)

S.No.	Test Parameter	Unit	Result	Acceptable limit	Permissible limit in absence of alternate source	Test Method
1	Colour	Colour Units	BDL	5	15	IS: 3025 (Part-4)Cl 2.0 [DL- 5 Colour Units]
2	Odour	-	Agreeable	Agreeable	Agreeable	IS:3025 (Part-5)
3	pH @ 25°C	-	7.33	6.5-8.5	No relaxation	IS:3025 (Part-11) [DL- 2]
4	Taste	-	Agreeable	Agreeable	Agreeable	IS: 3025 (Part-8)
5	Turbidity	NTU	BDL	1	5	IS 3025 (Part-10) (DL- 1 NTU)
6	Total Dissolved Solids	mg/l	417	500	2000	IS :3025 (Part-16) [DL- 5 mg/l]
7	Aluminum as Al.	mg/l	BDL	0.03	0.2	APHA-23rd Ed -3111D NO2- Ac Flame AAS Method [DL- 0.02 mg/l]
8	Ammonia as NH3-N	mg/l	BDL	0.5	No relaxation	IS:3025 (Part-34) Cl 2.5-Titrimetric Method [DL- 0.3 mg/l]
9	Barium as Ba	mg/l	BDL	0.7	No relaxation	IS :13428 Annex F [DL- 0.5 mg/l]
10	Boron as B	mg/l	BDL	0.5	2.4	APHA-23rd Ed - 4500B Curcumin Method [DL- 0.05 mg/l]
11	Calcium as Ca	mg/l	74	75	200	IS:3025 (Part-40) [DL- 5 mg/l]
12	Chloramines as Cl2.	mg/l	BDL	4.0	No relaxation	APHA-23rd Ed 2017-4500G [DL- 0.1 mg/l]
13	Chloride as Cl	mg/l	43	250	1000	IS: 3025 (Part-32) [DL- 1 mg/l]
14	Copper as Cu.	mg/l	BDL	0.05	1.5	APHA-23rd Ed -3111B A-Ac Flame AAS Method [DL- 0.02 mg/l]
15	Fluoride as F	mg/l	0.39	1.0	1.5	IS: 3025 (Part-60) [DL- 0.2 mg/l]
16	Iron as Fe	mg/l	0.19	1.0	No relaxation	APHA-23rd Ed -3500Fe-B Phenanthroline

Dr. Ajay Kumar

Authorized Signatory-Chemical & Biological

ULR No. : NA

Test Report No. : GWAM180723GE025

Type of Sample : Water (Ground Water)

Date of Reporting : 21/07/2023

16						Method [DL- 0.05 mg/l]
17	Magnesium as Mg	mg/l	6.1	30	100	IS :3025 (Part-46) [DL- 1 mg/l]
18	Manganese as Mn.	mg/l	BDL	0.1	0.3	APHA-23rd Ed 3111B A-Ac Flame AAS Method [DL- 0.1 mg/l]
19	Nitrate as NO3	mg/l	7.4	45	No relaxation	IS :3025 (Part-34) -Cl 3.3, Chromotropic Acid Method [DL- 1 mg/l]
20	Sulphate as SO4	mg/l	36	200	400	IS :3025 (Part-24) Cl 4.0 [DL- 1 mg/l]
21	Sulphide as H2S	mg/l	BDL	0.05	No relaxation	IS:3025 (Part-29) Cl 3.0, Methylene Blue Method [DL- 0.01 mg/l]
22	Total alkalinity as CaCO3	mg/l	225	200	600	IS :3025 (Part-23) [DL- 1 mg/l]
23	Total hardness as CaCO3	mg/l	210	200	600	IS :3025 (Part-21) [DL- 1 mg/l]
24	Zinc as Zn.	mg/l	BDL	5	15	APHA-23rd Ed- 3111B A-Ac Flame AAS Method [DL- 0.1 mg/l]
25	Cadmium as Cd.	mg/l	BDL	0.003	No relaxation	APHA-23rd Ed- 3111B A-Ac Flame AAS Method [DL- 0.001 mg/l]
26	Lead as Pb.	mg/l	BDL	0.01	No relaxation	APHA-23rd Ed- 3111B A-Ac Flame AAS Method [DL- 0.01 mg/l]
27	Mercury as Hg.	mg/l	BDL	0.001	No relaxation	APHA-23rd Ed-3112B [DL- 0.0005 mg/l]
28	Nickel as Ni	mg/l	BDL	0.02	No relaxation	APHA-23rd Ed-3111B A-Ac Flame AAS Method [DL- 0.02 mg/l]
29	Total arsenic as As.	mg/l	BDL	0.01	No relaxation	APHA-23rd Ed-3114C Hydride Generation [DL- 0.01 mg/l]
30	Total chromium as Cr	mg/l	BDL	0.05	No relaxation	IS :3025 (Part-52) Cl 7.0 [DL- 0.05 mg/l]

II -Biological Testing

1. Water (Ground Water)

S.No.	Test Parameter	Unit	Result	Acceptable limit	Permissible limit in absence of alternate source	Test Method
1	Total coliform	CFU/100ml	Absent	Absent	-	IS:15185
2	E.coli.	CFU/100ml	Absent	Absent	-	IS:15185

Remarks : NA

OTHER INFORMATION

Abbreviation : ULR: Unique Lab Report, BDL: Below Detection Level, NA: Not Applicable

Terms & Conditions : Please refer terms and conditions on backside of Test Report (Page-1)

End of Report



Dr. Ajay Kumar

Authorized Signatory-Chemical & Biological

TEST REPORT

ULR No. : NA		Test Report No. : GWAM180723GE024	
Type of Sample : Water (Ground Water)		Date of Reporting : 21/07/2023	
Customer	Group Housing Project "Homeland Regalia" By M/s S.A.Global Pvt.Ltd. Sector-77,SAS Nagar Mohali, Punjab	Work Order No. & Date	Work Order Dt.: 28/06/2023
		Customer reference No. (If any)	NA
Sampling Protocol	IS:17614 (P-1) 2021	Mode of Collection of Sample	Sampling by laboratory
Date of Sampling	18/07/2023	Date of Receipt of Sample	18/07/2023
Sampling Location	Borewell at Gurudwara Sahib Mata Sunder Kaur Ji	Testing Location	Permanent Facility
Testing Protocol	IS:10500-2012 (IInd Revision)	Period of Analysis	18/07/2023 To 21/07/2023
Sample Description	Colourless liquid.		
Packing, Markings, Seal & Qty.	2 litre Plastic & 500ml Glass Bottle Marked H/18/01		

RESULTS

I -Chemical Testing

1. Water (Ground Water)

S.No.	Test Parameter	Unit	Result	Acceptable limit	Permissible limit in absence of alternate source	Test Method
1	Colour	Colour Units	BDL	5	15	IS: 3025 (Part-4)CI 2.0 [DL- 5 Colour Units]
2	Odour	-	Agreeable	Agreeable	Agreeable	IS:3025 (Part-5)
3	pH @ 25°C	-	7.41	6.5-8.5	No relaxation	IS:3025 (Part-11) [DL- 2]
4	Taste	-	Agreeable	Agreeable	Agreeable	IS: 3025 (Part-8)
5	Turbidity	NTU	BDL	1	5	IS 3025 (Part-10) (DL- 1 NTU)
6	Total Dissolved Solids	mg/l	427	500	2000	IS :3025 (Part-16) [DL- 5 mg/l]
7	Aluminum as Al.	mg/l	BDL	0.03	0.2	APHA-23rd Ed -3111D NO2- Ac Flame AAS Method [DL- 0.02 mg/l]
8	Ammonia as NH3-N	mg/l	BDL	0.5	No relaxation	IS:3025 (Part-34) CI 2.5-Titrimetric Method [DL- 0.3 mg/l]
9	Barium as Ba	mg/l	BDL	0.7	No relaxation	IS :13428 Annex F [DL- 0.5 mg/l]
10	Boron as B	mg/l	BDL	0.5	2.4	APHA-23rd Ed - 4500B Curcumin Method [DL- 0.05 mg/l]
11	Calcium as Ca	mg/l	70	75	200	IS:3025 (Part-40) [DL- 5 mg/l]
12	Chloramines as Cl ₂ .	mg/l	BDL	4.0	No relaxation	APHA-23rd Ed 2017-4500G [DL- 0.1 mg/l]
13	Chloride as Cl	mg/l	47	250	1000	IS: 3025 (Part-32) [DL- 1 mg/l]
14	Copper as Cu.	mg/l	BDL	0.05	1.5	APHA-23rd Ed -3111B A-Ac Flame AAS Method [DL- 0.02 mg/l]
15	Fluoride as F	mg/l	0.61	1.0	1.5	IS: 3025 (Part-60) [DL- 0.2 mg/l]
16	Iron as Fe	mg/l	0.18	1.0	No relaxation	APHA-23rd Ed -3500Fe-B Phenanthroline

Dr. Ajay Kumar

Authorized Signatory-Chemical & Biological

ULR No. : NA

Test Report No. : GWAM180723GE024

Type of Sample : Water (Ground Water)

Date of Reporting : 21/07/2023

16						Method [DL- 0.05 mg/l]
17	Magnesium as Mg	mg/l	12	30	100	IS :3025 (Part-46) [DL- 1 mg/l]
18	Manganese as Mn.	mg/l	BDL	0.1	0.3	APHA-23rd Ed 3111B A-Ac Flame AAS Method [DL- 0.1 mg/l]
19	Nitrate as NO3	mg/l	8.8	45	No relaxation	IS :3025 (Part-34) -Cl 3.3, Chromotropic Acid Method [DL- 1 mg/l]
20	Sulphate as SO4	mg/l	34	200	400	IS :3025 (Part-24) Cl 4.0 [DL- 1 mg/l]
21	Sulphide as H2S	mg/l	BDL	0.05	No relaxation	IS:3025 (Part-29) Cl 3.0, Methylene Blue Method [DL- 0.01 mg/l]
22	Total alkalinity as CaCO3	mg/l	230	200	600	IS :3025 (Part-23) [DL- 1 mg/l]
23	Total hardness as CaCO3	mg/l	225	200	600	IS :3025 (Part-21) [DL- 1 mg/l]
24	Zinc as Zn.	mg/l	BDL	5	15	APHA-23rd Ed- 3111B A-Ac Flame AAS Method [DL- 0.1 mg/l]
25	Cadmium as Cd.	mg/l	BDL	0.003	No relaxation	APHA-23rd Ed- 3111B A-Ac Flame AAS Method [DL- 0.001 mg/l]
26	Lead as Pb.	mg/l	BDL	0.01	No relaxation	APHA-23rd Ed- 3111B A-Ac Flame AAS Method [DL- 0.01 mg/l]
27	Mercury as Hg.	mg/l	BDL	0.001	No relaxation	APHA-23rd Ed-3112B [DL- 0.0005 mg/l]
28	Nickel as Ni	mg/l	BDL	0.02	No relaxation	APHA-23rd Ed-3111B A-Ac Flame AAS Method [DL- 0.02 mg/l]
29	Total arsenic as As.	mg/l	BDL	0.01	No relaxation	APHA-23rd Ed-3114C Hydride Generation [DL- 0.01 mg/l]
30	Total chromium as Cr	mg/l	BDL	0.05	No relaxation	IS :3025 (Part-52) Cl 7.0 [DL- 0.05 mg/l]

II -Biological Testing

1. Water (Ground Water)

S.No.	Test Parameter	Unit	Result	Acceptable limit	Permissible limit in absence of alternate source	Test Method
1	Total coliform	CFU/100ml	Absent	Absent	-	IS:15185
2	E.coli.	CFU/100ml	Absent	Absent	-	IS:15185

Remarks : NA

OTHER INFORMATION

Abbreviation : ULR: Unique Lab Report, BDL: Below Detection Level, NA: Not Applicable

Terms & Conditions : Please refer terms and conditions on backside of Test Report (Page-1)

End of Report

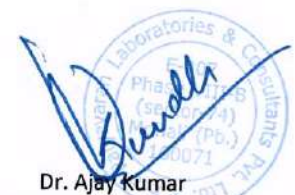

Dr. Ajay Kumar

Authorized Signatory-Chemical & Biological



TEST REPORT

ULR No. : NA		Test Report No. : NSOM161023NA028	
Type of Sample : Soil.		Date of Reporting : 18/10/2023	
Customer	Group Housing Project "Homeland Regalia" By M/s S.A.Global Pvt.Ltd. Sector-77,SAS Nagar Mohali, Punjab	Work Order No. & Date	Telephonic Confirmation DT:05.10.2023
		Customer reference No. (If any)	NA
Sampling Protocol	USEPA/600/R-92/128	Mode of Collection of Sample	Sampling by laboratory
Date of Sampling	16/10/2023	Date of Receipt of Sample	16/10/2023
Sampling Location	Park Near Sales Office (Project Site)	Testing Location	Permanent Facility
Testing Protocol	IS Method	Period of Analysis	16/10/2023 To 18/10/2023
Sample Description	Brown coloured soil.		
Packing, Markings, Seal & Qty.	10 Kg Poly Bag Marked HR/16/01		

RESULTS

I. Chemical Testing

1. Pollution & Environment (Soil)

S.No.	Test Parameter	Unit	Result	Test Method
1	pH	--	8.05	IS:2720 (Part-26) Cl-2, [DL- 2]
2	Conductivity	mmhos/cm	0.304	IS:14767 [DL- 0.1 mmhos/cm]
3	Moisture Content	%	9.2	IS:2720 (Part-II) Sec-1 [DL- 0.1 %]
4	Organic Matter	%	1.51	IS: 2720 (Part XXII) Sec-1, [DL- 0.1 %]
5	Texture	--	Sandy Loam	IS:2720 (Part-4) Cl 2,4
6	Bulk Density	gm/cc	1.56	IS: 2720 (Part-7) [DL- 1 gm/cc]

Remarks : NA

OTHER INFORMATION

Abbreviation : ULR: Unique Lab Report, BDL: Below Detection Level, NA: Not Applicable

Terms & Conditions : Please refer terms and conditions on backside of Test Report (Page-1)

End of Report



Umesh Kumar
Authorized Signatory-Chemical



TEST REPORT

ULR No. : NA		Test Report No. : NAIM171023NA011	
Type of Sample : Ambient Air Quality		Date of Reporting : 18/10/2023	
Customer	Group Housing Project "Homeland Regalia" By M/s S.A.Global Pvt.Ltd. Sector-77,SAS Nagar Mohali, Punjab	Work Order No. & Date	Telephonic Confirmation DT:05.10.2023
		Customer reference No. (If any)	NA
Sampling Protocol	IS:5182 and CPCB Air Manual Volume-I (NAAQMS/36/2012-13) / CPCBNAAQS-2009	Mode of Collection of Sample	Sampling by laboratory
Date of Sampling	16/10/2023	Date of Receipt of Sample	17/10/2023
Sampling Location	Project Site (Near Sales Office)	Period of Analysis	17/10/2023 To 18/10/2023
Testing Protocol	IS:5182 and CPCB Air Manual Volume-I (NAAQMS/36/2012-13) / CPCBNAAQS-2009	Environmental Conditions	Partially cloudy weather; Drizzling for approx 2-3 hrs.
Testing Location	On Site & Permanent Facility		

RESULTS

I-Chemical Testing

1. Atmospheric Pollution (Ambient Air)

S.No.	Test Parameter	Unit	Result	Standard	Method
1	Respirable Suspended Particulate Matter (as PM10)	µg/m ³	75	100	IS: 5182 (Part-23)
2	Particulate Matter (as PM2.5)	µg/m ³	49	60	Lab SOP: EL/SOP/AAQ/01, Issue No. 03, Jan 01
3	Sulphur Dioxide (as SO ₂)	µg/m ³	10	80	IS: 5182 (Part-2)
4	Nitrogen Dioxide (as NO ₂)	µg/m ³	24	80	IS: 5182 (Part-6)
5	Ammonia (as NH ₃)	µg/m ³	22	400	Lab SOP: EL/SOP/AAQ/02, Issue No. -03, Jan 01
6	Ozone (as O ₃)	µg/m ³	18	180	IS: 5182 (Part-9)
7	Carbon Monoxide (as CO),	mg/m ³	0.61	04	IS: 5182 (Part-10), NDIR Method

Remarks : NA

OTHER INFORMATION

Abbreviation :

ULR: Unique Lab Report, BDL: Below Detection Level, NA: Not Applicable

Terms & Conditions :

Please refer terms and conditions on backside of Test Report (Page-1)

****End of Report****





TEST REPORT

ULR No. : NA		Test Report No. : NNOM171023NA012	
Type of Sample : Ambient Noise		Date of Reporting : 18/10/2023	
Customer	Group Housing Project "Homeland Regalia" By M/s S.A.Global Pvt.Ltd. Sector-77,SAS Nagar Mohali, Punjab	Work Order No. & Date	Telephonic Confirmation DT:05.10.2023
		Customer reference No. (If any)	NA
Sampling Protocol	IS 9989-1989, RA 2008.	Mode of Collection of Sample	Sampling by laboratory
Date of Sampling	16/10/2023	Date of Receipt of Sample	17/10/2023
Sampling Location	Project Site (Near Sales Office)	Period of Analysis	17/10/2023 To 17/10/2023
Testing Protocol	IS 9989-1989, RA 2008.		
Testing Location	On Site & Permanent Facility		

RESULTS

I- Chemical Testing

1. Atmospheric Pollution (Ambient Noise Level)

S.No.	Test Parameters	Units	Results	Method
1	Ambient Day Time Noise Levels	dB(A)	53.6	LAB SOP: EL/SOP/AN/01, Issue No.-04, Nov 10

Ambient Noise Quality Standards as per Noise Pollution (Regulation and Control) Rules, 2000

Area Code	Category of Area/Zone	Limits in dB(A) Leq*	
		Day Time	Night Time
A	Industrial area	75	70
B	Commercial area	65	55
C	Residential area	55	45
D	Silence Zone	50	40

Day time shall mean from 6.00 a.m. to 10.00 p.m., Night time shall mean from 10.00 p.m. to 6.00 a.m., Silence zone is an area comprising not less than 100 meters around hospitals, educational institutions, courts, religious places or any other area which is declared as such by the competent authority, Mixed categories of areas may be declared as one of the four above mentioned categories by the competent authority.

*dB(A) Leq denotes the time weighted average of the level of sound in decibels on scale 'A' which is relatable to human hearing

Remarks : NA

OTHER INFORMATION

Abbreviation : ULR: Unique Lab Report, BDL: Below Detection Level, NA: Not Applicable

Terms & Conditions : Please refer terms and conditions on backside of Test Report (Page-1)

End of Report

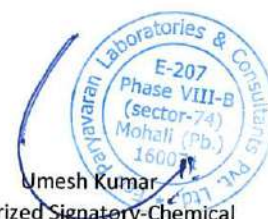



ਗਰੇਟਰ ਮੋਹਾਲੀ ਏਰੀਆ ਡਿਵੈਲਪਮੈਂਟ ਅਥਾਰਿਟੀ

ਕਮਰਾ ਨੰ. 535, ਪੰਜਵੀਂ ਮੰਜ਼ਿਲ, ਪੁੱਡਾ ਭਵਨ,

ਸੈਕਟਰ - 62, ਐਸ.ਏ.ਐਸ.ਨਗਰ

ਵੱਲ:

M/s S.A. Global Private Limited,
Group Housing Site, Sector77,
SAS Nagar.

ਪੱਤਰ ਨੰ: ਗਮਾਡਾ/ਮੰ.ਇੰਜੀ.(ਜਸ-1)/2023/2057 ਮਿਤੀ: 20-07-2023

ਵਿਸ਼ਾ:- NOC for Sewerage Connection, Collection of Solid Waste, Storm Water Connection in respect of the Group Housing Project " Homeland Regalia" Situated at Group Housing Site, Sector 77, SAS Nagar (Mohali) and further clarification regarding the fact that GMADA Sewer has capacity for the disposal of 150 kid of excess load from the our Group Housing Project.

ਹਵਾਲਾ: ਆਪ ਵੱਲੋਂ ਪ੍ਰਾਪਤ ਪੱਤਰ ਨੰ. ਨਿੱਲ ਮਿਤੀ 07.07.2023.

ਉਪਰੋਕਤ ਵਿਸ਼ੇ ਅਤੇ ਹਵਾਲੇ ਅਧੀਨ ਪੱਤਰ ਦੇ ਸਬੰਧ ਵਿੱਚ ਦੱਸਿਆ ਜਾਂਦਾ ਹੈ ਕਿ ਇਸ ਗਰੁੱਪ ਹਾਊਸਿੰਗ ਸਾਈਟ ਦੇ ਪ੍ਰਵਾਨਿਤ ਸਰਵਿਸ ਪਲੈਨ ਅਨੁਸਾਰ ਸੀਵਰੇਜ ਲਈ ਸਾਈਟ ਵਿੱਚ 2 ਨੰਬਰ ਐਸ.ਟੀ.ਪੀ. 265 KLD (245 KLD + 20 KLD) ਦੇ ਲਗਾਏ ਜਾਣਗੇ। ਜਿਸ ਦਾ 135 KLD (123 KLD + 12 KLD) excess ਟ੍ਰਸ਼ਰੀ ਟ੍ਰੀਟਡ ਵਾਟਰ ਗਮਾਡਾ ਦੀ ਸੀਵਰੇਜ ਲਾਈਨ ਵਿੱਚ ਡਿਸਪੋਜ਼ ਕੀਤਾ ਜਾ ਸਕੇਗਾ। ਜਿਸ ਦਾ ਰਿਕਾਰਡ ਫਲੋਅ ਮੀਟਰ ਰਾਹੀਂ ਰੱਖਿਆ ਜਾਵੇਗਾ। ਇਸ ਤੋਂ ਇਲਾਵਾ ਮਿਲਖ ਅਫਸਰ (ਪ), ਗਮਾਡਾ ਐਸ.ਏ.ਐਸ.ਨਗਰ ਜੀ ਦੇ ਦਫਤਰ ਦੇ ਪੱਤਰ ਨੰ. 90776 ਮਿਤੀ 10.12.2021 ਦੀ ਸ਼ਰਤ ਨੰ. 19 ਅਨੁਸਾਰ ਇਸ ਸਾਈਟ ਦੇ ਸੋਲਿਡ ਵੇਸਟ ਦਾ ਪ੍ਰਬੰਧ ਅਲਾਟੀ ਵੱਲੋਂ ਆਪਣੇ ਪੱਧਰ ਤੇ ਕੀਤਾ ਜਾਣਾ ਹੈ। ਪ੍ਰਵਾਨਤ ਬਿਲਡਿੰਗ ਪਲੈਨਾਂ ਅਨੁਸਾਰ ਇਸ ਸਾਈਟ ਦੇ ਸਟਾਰਮ ਨੂੰ ਸਾਈਟ ਅੰਦਰ ਬਣਨ ਵਾਲੇ ਰਿਚਾਰਜਵੈੱਲ ਦੇ ਓਵਰਫਲੋਅ ਬਰਸਾਤੀ ਪਾਣੀ ਨੂੰ ਸੈਕਟਰ 77 ਦੀ ਮੇਨ ਸਟਾਰਮ ਵਾਟਰ ਡ੍ਰੇਨੇਜ ਲਾਈਨ ਵਿੱਚ ਆਪਣੇ ਪੱਧਰ ਤੇ ਕੂਨੈਕਟ ਕੀਤਾ ਜਾਵੇਗਾ।

Rajne 20/07
ਮੰਡਲ ਇੰਜੀਨੀਅਰ (ਜਸ-1)
ਗਮਾਡਾ, ਐਸ.ਏ.ਐਸ. ਨਗਰ। ੧

ਪਿੱਠ ਅੰਕਣ ਨੰ: ਗਮਾਡਾ/ਮੰ.ਇੰਜੀ.(ਜਸ-1)/2023/

ਮਿਤੀ:

ਉਪਰੋਕਤ ਦਾ ਉਤਾਰਾ ਹੇਠ ਲਿਖਿਆ ਨੂੰ ਸੂਚਨਾ ਹਿੱਤ ਭੇਜਿਆ ਜਾਂਦਾ ਹੈ ਜੀ:-

- 1) ਮਿਲਖ ਅਫਸਰ (ਪ), ਗਮਾਡਾ ਐਸ.ਏ.ਐਸ.ਨਗਰ।
- 2) ਨਿਗਰਾਨ ਇੰਜੀਨੀਅਰ (ਸਿ-1), ਗਮਾਡਾ ਐਸ.ਏ.ਐਸ.ਨਗਰ।
- 3) ਉਪ ਮੰਡਲ ਇੰਜੀਨੀਅਰ (ਜਸ-2), ਗਮਾਡਾ ਐਸ.ਏ.ਐਸ.ਨਗਰ ਨੂੰ ਉਨ੍ਹਾਂ ਵੱਲੋਂ ਮਿਤੀ 17.07.2023 ਕੀਤੀ ਗਈ ਰਿਪੋਰਟ ਦੇ ਹਵਾਲੇ ਵਿੱਤ ਭੇਜਿਆ ਜਾਂਦਾ ਹੈ।

ਮੰਡਲ ਇੰਜੀਨੀਅਰ (ਜਸ-1),
ਗਮਾਡਾ, ਐਸ.ਏ.ਐਸ.ਨਗਰ।



GREATER MOHALI AREA DEVELOPMENT AUTHORITY,
PUDA BHAWAN, SECTOR-62, SAS NAGAR (MOHALI)

To

S.A. Global Pvt. Ltd.
Unit No. 14, Plot No. 31, LGF
Vikas Tower Building, Pitampura
New Delhi.

No. GMADA/CE/2020/1957
Dated: 22-12-2020

Sub: Confirmation regarding the supply of water, sewerage connection and waste disposal for Group Housing Site, Opp Mata Sundar Kaur Gurdwara, 200 ft Airport Road, SAS Nagar (Mohali).

Ref: Your office letter No. Nil dated 19-12-2020 and Memo No. 46711 Dated 20-11-2020 of EO(P), GMADA, Mohali

Please refer to the office Memos as above.

It is brought in to your notice that since you were the successful bidder for the Group Housing Site, Sec-77 (opposite Gurudwara Mata Sundar Kaur, at junction Sec71, 70, 76 & 77) during the Auction held by GMADA vide your Auction ID 2463, GMADA is bound to handover the site in fully developed Sector, meaning there by that trunk water supply, Sewerage and Storm Water Drainage line will be provided by GMADA outside the site in question allotted to you. However, being a Bulk Waste Generator, you will have to make your own arrangements for the Solid Waste Management, as per the Solid Waste Management Rules notified by Government.

22/12
Chief Engineer,
GMADA

Pollution Under Control Certificate

Authorised By :
Government of Punjab

Date : **23/05/2023**
Time : **15:50:27 PM**
Validity upto : **22/11/2023**



Certificate SL. No. : PB06500590011982
Registration No. : PB09H9135
Date of Registration : 01/Nov/2005
Month & Year of Manufacturing : November-2005
Valid Mobile Number : *****3591
Emission Norms : BHARAT STAGE IV
Fuel : DIESEL
PUC Code : PB0650059
GSTIN :
Fees : Rs.100.00
(GST to be paid extra as applicable)
MIL observation : No

Vehicle Photo with Registration plate
60 mm x 30 mm



Sr. No.	Pollutant (as applicable)	Units (as applicable)	Emission limits	Measured Value (upto 2 decimal places)
1	2	3	4	5
Idling Emissions	Carbon Monoxide (CO)	percentage (%)		
	Hydrocarbon, (THC/HC)	ppm		
High idling emissions	CO	percentage (%)		
	RPM	RPM	2500 ± 200	
	Lambda	-	1 ± 0.03	
Smoke Density	Light absorption coefficient	1/metre	1.62	0.73

This PUC certificate is system generated through the national register of motor vehicles and does not require any signature.

Note : 1. Vehicle owners to link their mobile numbers to registered vehicle by logging to <https://puc.parivahan.gov.in>

Authorised Signature with stamp of PUC operator
60mm x 20 mm

MOHALI SERVICE STATION
Indian Oil Petrol Pump & CNG Station,
Sector-70, Mohali

[See rules 115 (2)]

Pollution Under Control Certificate

Authorised By :
Government of Punjab

Date : 23/05/2023
Time : 16:13:15 PM
Validity upto : 22/11/2023



Certificate SL. No. : PB06500590011984
Registration No. : PB65AK8651
Date of Registration : 17/Mar/2017
Month & Year of Manufacturing : December-2016
Valid Mobile Number : *****0882
Emission Norms : BHARAT STAGE IV
Fuel : DIESEL
PUC Code : PB0650059
GSTIN :
Fees : Rs.100.00
(GST to be paid extra as applicable)
MIL observation : No

Vehicle Photo with Registration plate
60 mm x 30 mm

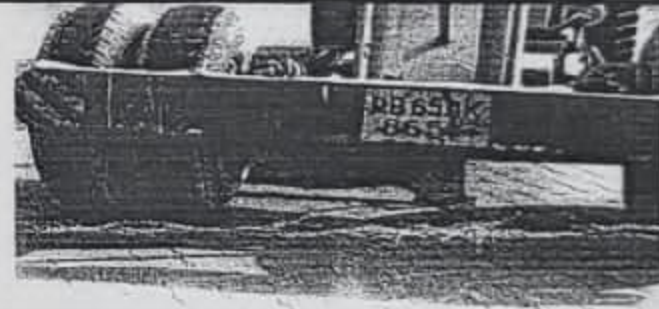

Sr. No.	Pollutant (as applicable)	Units (as applicable)	Emission limits	Measured Value (upto 2 decimal places)
1	2	3	4	5
Idling Emissions	Carbon Monoxide (CO)	percentage (%)		
	Hydrocarbon, (THC/HC)	ppm		
High idling emissions	CO	percentage (%)		
	RPM	RPM	2500 ± 200	
	Lambda	-	1 ± 0.03	
Smoke Density	Light absorption coefficient	1/metre	1.62	0.74

This PUC certificate is system generated through the national register of motor vehicles and does not require any signature.

Note : 1. Vehicle owners to link their mobile numbers to registered vehicle by logging to <https://puc.parivahan.gov.in>

Authorised Signature with stamp of PUC operator
60mm x 20 mm

LI SERVICE STATION
Indian Oil Petrol Pump & CNG Station
Sector-70, Mohali

[See rules 115 (2)]

Pollution Under Control Certificate

Authorised By :
Government of Punjab

Date : 23/05/2023
Time : 16:10:25 PM
Validity upto : 22/11/2023



Certificate SL. No. : PB06500590011983
Registration No. : PB12H4479
Date of Registration : 03/Nov/2005
Month & Year of Manufacturing : April-2005
Valid Mobile Number : *****6828
Emission Norms : BHARAT STAGE IV
Fuel : DIESEL
PUC Code : PB0650059
GSTIN :
Fees : Rs.100.00
(GST to be paid extra as applicable)
MIL observation : No

Vehicle Photo with Registration plate
60 mm x 30 mm



Sr. No.	Pollutant (as applicable)	Units (as applicable)	Emission limits	Measured Value (upto 2 decimal places)
1	Carbon Monoxide (CO)	percentage (%)		
	Hydrocarbon, (THC/HC)	ppm		
	CO	percentage (%)		
High idling emissions	RPM	RPM	2500 ± 200	
	Lambda	-	1 ± 0.03	
Smoke Density	Light absorption coefficient	1/metre	1.62	0.65

This PUC certificate is system generated through the national register of motor vehicles and does not require any signature.

Note : 1. Vehicle owners to link their mobile numbers to registered vehicle by logging to <https://puc.parivahan.gov.in>

Authorised Signature with stamp of PUC operator
10mm x 20 mm

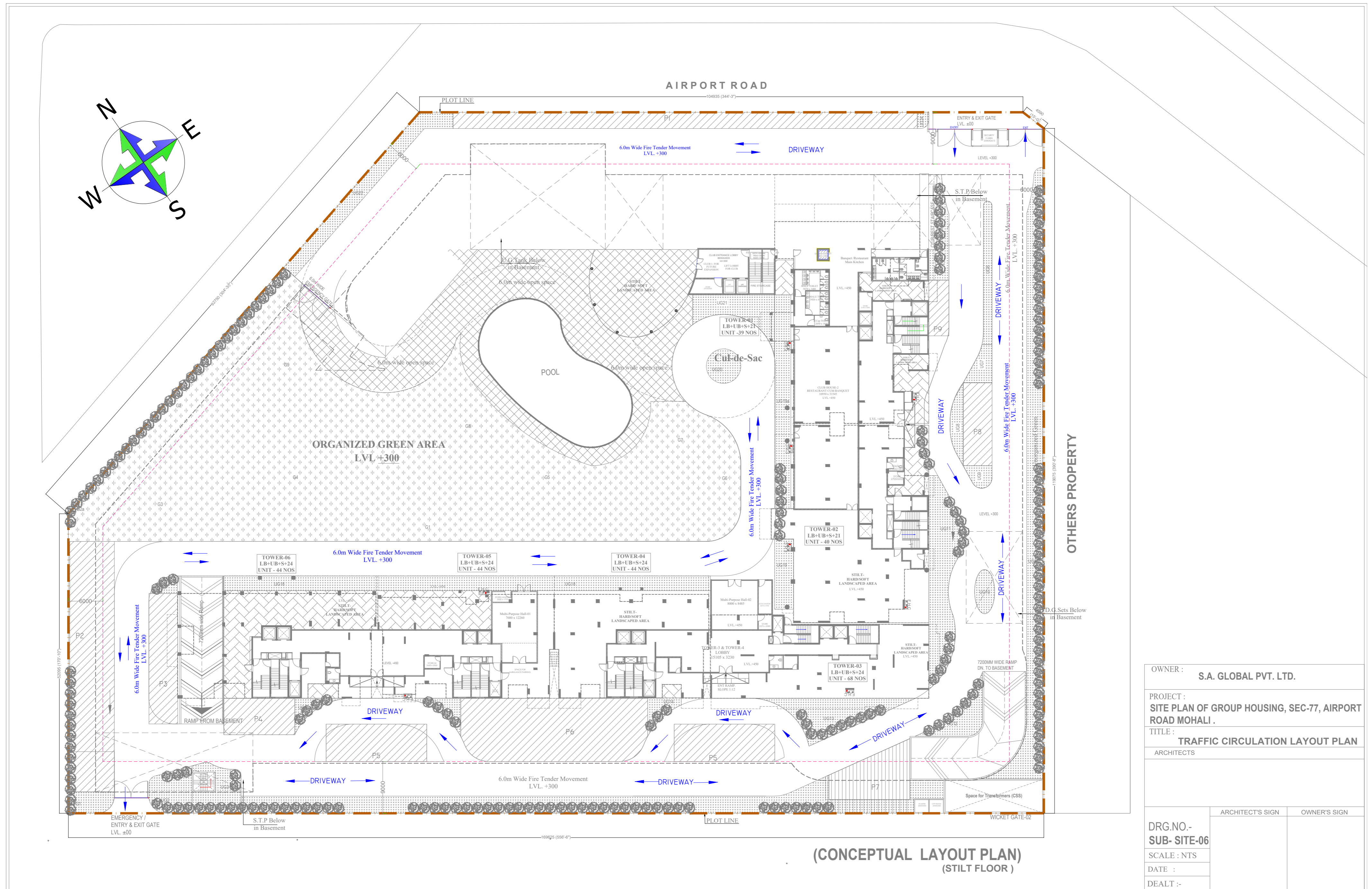

**(CONCEPTUAL LAYOUT PLAN)
(STILT FLOOR)**

OWNER :	S.A. GLOBAL PVT. LTD.	
PROJECT :	SITE PLAN OF GROUP HOUSING, SEC-77, AIRPORT ROAD MOHALI .	
TITLE :	TRAFFIC CIRCULATION LAYOUT PLAN	
ARCHITECTS		
DRG.NO.- SUB- SITE-06	ARCHITECT'S SIGN	OWNER'S SIGN
SCALE : NTS		
DATE :		
DEALT :-		

TRAFFIC CALMING MEASURES

INTRODUCTION:

Traffic calming uses physical design and other measures to improve safety for motorists, pedestrians and cyclists. It has become a tool to combat speeding and other unsafe behaviors of drivers in the neighborhoods. It aims to encourage safer, more responsible driving and potentially reduce traffic flow. Strategies for traffic calming include narrowed roads and speed humps.

CLASSIFICATION OF TRAFFIC CALMING TECHNIQUES:

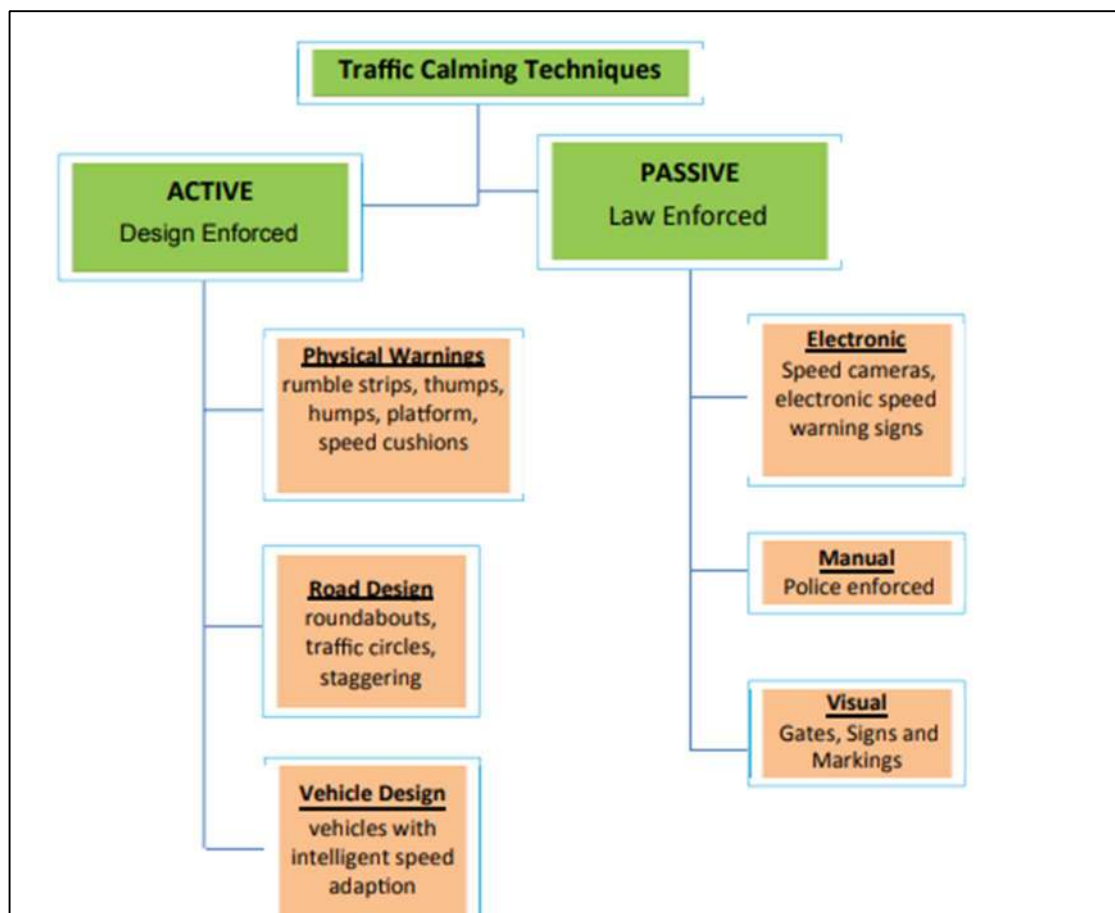

1. Active Measures:

➤ Lane Narrowing

It can reduce the speed of cars but its effect is minimal for two wheelers. Also, in the case of bicycle lanes, there are more chances of the lane being encroached upon by the motorized vehicle due to a constricted carriageway. As a suggestion, narrowing should be indicated using lane marking instead of geometric intervention.

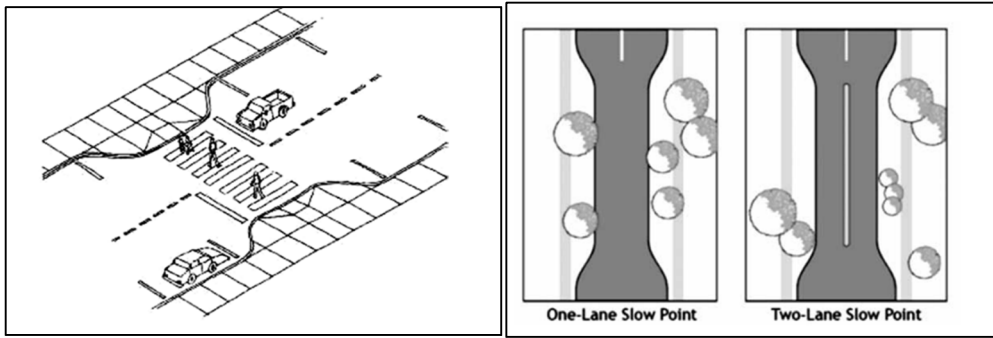

➤ **Speed Breakers/ Humps**

Speed breakers are commonly used to reduce speeds. However, the design and type of the speed breaker is critical. Speed breakers reduce the speed and result in an efficient traffic flow. The advantage of speed breakers is that they can be easily placed at identified locations. Humps as a speed reducing device work on the basis of the slight inconvenience in the form of a jerk and vertical acceleration, caused to the driver.

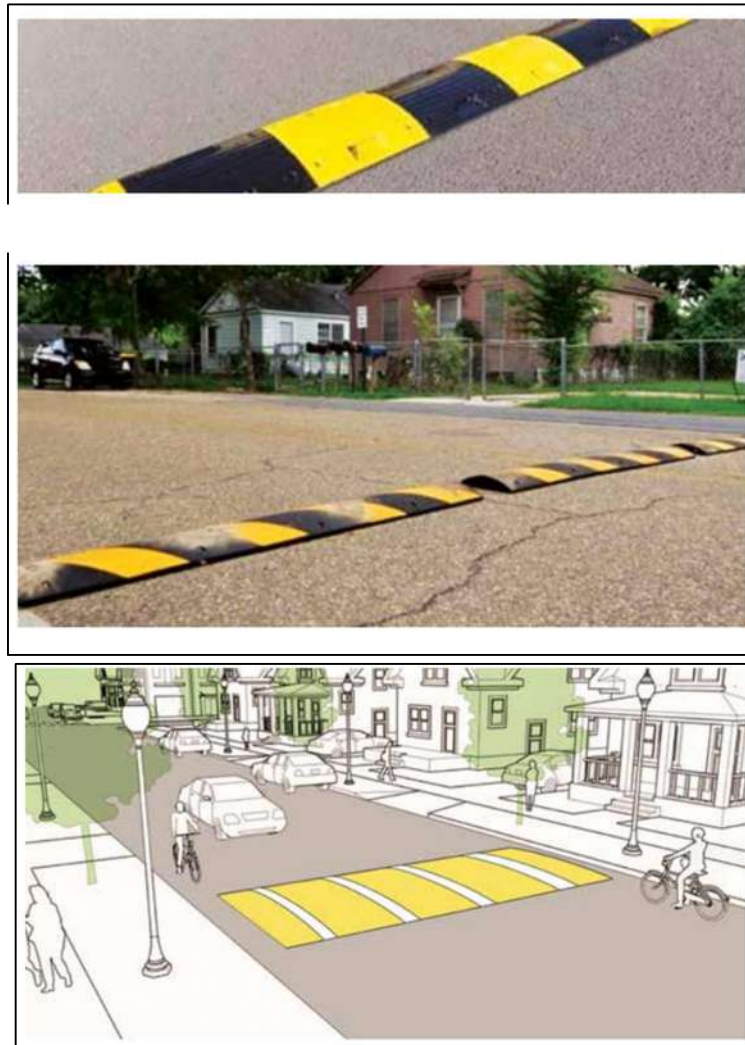

➤ **Speed Tables, Raised Crossings, Raised Intersections**

These are effective methods to bring all users to a common speed limit without affecting the cyclists too much. They can be mainly used on nodes/junctions between access and arterial or access and distributor where the intervention does not affect the movement of through traffic in case of arterial and is done on the access arm.

Raised crossings are standard designs used internationally to resolve conflicts between different kinds of traffic i.e. cars and other motor vehicles, cyclists and pedestrians and are predominantly used at minor junctions, property entrances, entry and exit to service roads; to provide comfort, convenience and safety to all users.



➤ **Roundabouts**

Roundabout is a junction type to reduce the speed of traffic while passing through junction. The central island and deflecting islands are designed in such a way that traffic has to be deflected to reduce the speed before entering circulatory carriageway. In the roundabout high speed conflicts can be avoided.

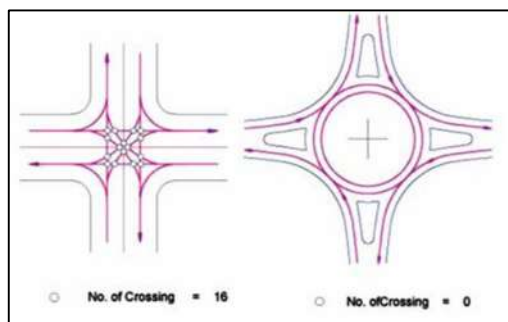

2. Passive or Law enforced:

Passive or Law enforced Passive measures include speed cameras and electronically displayed speed warning signs and the restrictions enforced by police manually for certain traffic

movements, and also visual measures like gates, signs and markings, whereby law can be enforced for those who are violating the instructions and crossing the limits set therein

➤ **Visual Warnings or Pre-Warnings**



Pre-warnings are applied to ensure that drivers become aware of the subsequent speed reducers or changing road speed classification.

Pre-warnings will normally be applied on traffic roads before stretches of speed control and can be used for all traffic flows.

➤ **Signs**

Road sign warns and informs the drivers about the nature of the road stretch that they are approaching and about the local speed limit or recommended speed for that road stretch. IRC:67 for “Code of Practice for Road Signs” have been followed for recommended road signs in India.

	Stop
	Give Way
	No Entry
	One Way
	Overtaking Prohibited
	Horn Prohibited
	No Parking
	Speed Limit
	Pedestrian Crossing
	School Ahead

	Cycle Crossing
	Men at Work
	Round About

सार्वजनिक सूचना

यह आम जनता की जानकारी के लिए है कि मैसर्ज एस.ए. ग्लोबल प्राइवेट लिमि. में हमारे एन्वायरनमेंट कंसल्टेंट, मैसर्ज ईको लैबोरेट्रीज एंड कंसल्टेंट्स प्राइवेट लिमि. मोहाली के माध्यम से एफ नं. 21-110/2020-1ए-III तिथि 23.02.2021 के अनुसार सेक्टर-77, जिला एसएस नगर (मोहाली) पंजाब में स्थित ग्रुप हाऊसिंग प्रोजैक्ट नामतः "होमलैंड रेजीडेंसिस" सम्मिलित 6 रेजीडेंशियल टावर्स और 18 दुकानों के विकास के लिए एमओईएफ और सीसी से एन्वायरनमेंट क्लीयरेंस प्राप्त की है। एन्वायरनमेंटल क्लीयरेंस की कापी के साथ-साथ अनुपालन की जाने वाली शर्तें एन्वायरनमेंटल क्लीयरेंस पोर्टल पर और प्रोजैक्ट प्रोपोनैट के साथ उपलब्ध है। इच्छुक व्यक्ति चाहे दोनों से, 1. मैसर्ज एम.ए. ग्लोबल प्राइवेट लिमि., यूनिट नं. 14 प्लाट नं. 31, लोअर ग्राऊंड फ्लोर रोड नं. 44 विकास टावर, बिल्डिंग, रानी बाग कम्युनिटी सेंटर, पीतमपुरा, नई दिल्ली सरस्वती विहार नार्थ वेस्ट दिल्ली-110034, 2. मैसर्ज ईको लैबोरेट्रीज एंड कंसल्टेंट प्राइवेट लिमि. ई-207, इंडस्ट्रीयल एरिया फेस VIII-बी, सेक्टर 74, मोहाली, पंजाब में सम्पर्क कर सकता है।

PUBLIC NOTICE

It is for the information of General Public that M/s S.A. Global Pvt. Ltd. has been granted Environmental Clearance by MoEF & CC for development of Group Housing Project namely "Homeland Residences" comprising of 6 Residential Towers and 18 Shops located at Sector-77, Distt. S.A.S. Nagar (Mohali) Punjab vide F.No. 21-110/2020-IA-III dated 23.02.2021 through our Environmental Consultant "M/s Eco Laboratories & Consultants Pvt. Ltd., Mohali". The copy of the Environmental Clearance along with the conditions to be complied is available with Environmental Clearance portal and with the Project proponent. The interested person can contact either of the two.

1. M/s. S.A. Global Pvt. Ltd. Unit No., 14, Plot No. 31, Lower Ground Floor, Road No. 44, Vikas Tower Building, Rani Bagh, Community Center, Pitampura, New Delhi. Saraswati Vihar, North West Delhi- 110034

2. M/s. Eco Laboratories & Consultants Pvt. Ltd. E-207, Industrial Area, Phase VIII-B, Sector-74, Mohali, Punjab

ਪਬਲਿਕ ਨੋਟਿਸ

ਆਮ ਜਨ ਸਧਾਰਨ ਨੂੰ ਸੂਚਿਤ ਕੀਤਾ ਜਾਂਦਾ ਹੈ ਕਿ ਮੈਸ ਐਸ.ਏ. ਗਲੋਬਲ ਪ੍ਰਾ. ਲਿਮ. ਨੂੰ ਗਰੁੱਪ ਹਾਊਸਿੰਗ ਪ੍ਰੋਜੈਕਟ "ਹੋਮਲੈਂਡ ਰੈਜੀਡੈਂਸੀ" ਜਿਸ ਵਿੱਚ 6 ਰਹਾਇਸ਼ੀ ਟਾਵਰ ਅਤੇ 18 ਦੁਕਾਨਾਂ ਸਥਿਤੀ ਸੈਕਟਰ 77, ਜ਼ਿਲ੍ਹਾ ਐਸ.ਏ.ਐਸ. ਨਗਰ (ਮੋਹਾਲੀ) ਪੰਜਾਬ ਰਾਹੀਂ ਐਫ ਨੰ. 21-110/2020-IA-III ਮਿਤੀ 23.02.2021 ਰਾਹੀਂ ਸਾਡੇ ਇੰਵਾਇਰਮੈਂਟ ਕੰਸਲਟੈਂਟ "ਮੈਸ ਈਕੋ ਲੈਬੋਰੇਟਰੀਜ਼ ਐਂਡ ਕੰਸਲਟੈਂਟਜ਼ ਪ੍ਰ. ਲਿਮ. ਮੋਹਾਲੀ", ਲਈ ਐਮਓਈਐਫ ਐਂਡ ਸੀਸੀ ਵੱਲੋਂ ਇੰਨਵਾਇਰਮੈਂਟ ਕਲੀਅਰੈਂਸ ਦੇ ਦਿੱਤੀ ਗਈ ਹੈ। ਇੰਨਵਾਇਰਮੈਂਟ ਕਲੀਅਰੈਂਸ ਦੀ ਕਾਪੀ ਸਮੇਤ ਬਰਤਾਂ ਅਤੇ ਪ੍ਰੋਜੈਕਟ ਪ੍ਰਸਤਾਵ ਇੰਨਵਾਇਰਮੈਂਟ ਕਲੀਅਰੈਂਸ ਪੋਰਟਲ 'ਤੇ ਉਪਲਬਧ ਹਨ। ਚਾਹਵਾਨ ਵਿਅਕਤੀ ਹੇਠ ਲਿਖੇ ਦੋਨਾਂ ਵਿੱਚੋਂ ਕਿਸੇ ਨੂੰ ਵੀ ਸਪਰੰਕ ਕਰ ਸਕਦਾ ਹੈ:

1. ਮੈਸ ਐਸ.ਏ. ਗਲੋਬਲ ਪ੍ਰਾ. ਲਿਮ. ਯੂਨੀਟ ਨੰ. 14, ਪਲਾਟ ਨੰ. 31, ਲੋਅਰ ਗਰਾਉਂਡ ਮੰਜ਼ਿਲ, ਰੋਡ ਨੰ. 44, ਵਿਕਾਸ ਟਾਵਰ ਬਿਲਡਿੰਗ, ਰਾਣੀ ਬਾਗ, ਕਮਿਊਨਿਟੀ ਸੈਂਟਰ, ਪੀਤਮਪੁਰਾ, ਨਿਊ ਦਿੱਲੀ, ਸਰਸਵਤੀ ਵਿਹਾਰ, ਉਤਰ ਪੱਛਮ ਦਿੱਲੀ 110034

2. ਮੈਸ ਈਕੋ ਲੈਬੋਰੇਟਰੀਜ਼ ਐਂਡ ਕੰਸਲਟੈਂਟ ਪ੍ਰਾ. ਲਿਮ. ਈ-207, ਇੰਡਸਟਰੀਜ਼ ਏਗੀਆ, ਫੇਜ਼ 8-ਬੀ, ਸੈਕਟਰ 74, ਮੋਹਾਲੀ, ਪੰਜਾਬ

+91-99889-76767

SMS 56767 TO "HOMELAND"

FOR MORE DETAILS PLEASE WRITE TO:
INFO@HOMELANDREGALIA.COM

SEND

SALES GALLERY

Group Housing Site, Airport Road,
Sector 77, Sahibzada Ajit Singh Nagar,
Punjab 160070

SMS 56767 to "HOMELAND"

+91-99889-76767



PBRERA-SAS81-PR0757

<https://rera.punjab.gov.in/>

[Privacy Policy](#)

[Compliance Report](#)

[Form V](#)

[Environmental Clearance](#)

Property managed by

Activate Windows
Go to Settings to activate Windows.



RESERVE YOUR REGALIA VISIT



Draw



Read aloud

Ask Bing AI



1

of 64



S.A. GLOBAL PRIVATE LIMITED

Regd. Office: Group Housing Site, Sector 77, SAS Nagar, Mohali - 140308, Punjab, India
M: 79953 53802, **E-mail:** saglobal@homelandregalia.com, **CIN:** U51225PB2016PT10052956
Website: www.homelandregalia.com, **SMS:** HOMELAND to 56767

Date: 23.05.2023

To,
The Additional Director
Ministry of Environment, Forest and Climate Change,
Integrated Regional Office,
Bay No. 24-25, Sector-31A,
Dakshin Marg,
Chandigarh- 160030
(Mail ids: eccompliance-nro@gov.in and ronz cbd-mef@nic.in)

Subject: Submission of six monthly compliance report for period ending 31.03.2023 for the Group Housing Project namely "Homeland Regalia" (formally known as Homeland Residences) located at sector 77, Distt. SAS Nagar (Mohali), Punjab by M/s S.A. Global Pvt. Ltd.

Respected Sir,

With reference to the EIA Notification & its amendments regarding submission of six monthly compliance report, we are hereby submitting the six monthly compliance report for period ending 31.03.2023 for the above said project through mail for your perusal.

Kindly acknowledge the receipt of the same.

Thanking you
Sincerely
For M/s S.A. Global Pvt. Ltd.



(Authorized Signatory)
E-mail: saglobal@homelandregalia.com

CC: Member Secretary, SEIAA Punjab, Directorate of Environment and Climate Change, C/o Punjab State Council for Science & Technology, MGSIPA Complex, Sector 26, Chandigarh-160019 (Uploaded on PARIVESH portal)

Delete Archive Report Reply Reply all Forward Read / Unread Categorize Flag / Unflag Assign policy Print

Submission of **six monthly** compliance report for the period ending on 31.03.2023 for project "**Homeland Regalia**" (formerly known as "**Homeland Residences**" by M/s S.A. Global Pvt. Ltd.



Wed 5/31/2023 10:43 AM

SG S A GLOBAL <saglobal@homelandregalia.com>

To: ecompliance-nro@gov.in; ronzh.chd-mef@nic.in

Cc: eenodal@yahoo.in; seiaapb2017@gmail.com

Six Monthly Compliance_31....
16 MB

Respected Sir,

Greetings for the day!!!

We are hereby submitting **six monthly** compliance report for the period ending 31.03.2023 for our Group Housing project namely "**Homeland Regalia**" (formerly known as "**Homeland Residences**") located at Sector 77, District SAS Nagar (Mohali), Punjab.

Kindly acknowledge the receipt of the same.

Regards

M/s S.A. Global Pvt. Ltd.

Reply

Reply all

Forward

S.A. GLOBAL PRIVATE LIMITED

Regd. Office: Group Housing Site, Sector 77, SAS Nagar, Mohali - 140308, Punjab, India
M: 79863 53802, **E-mail:** saglobal@homelandregalia.com, **CIN:** U51225PB2016PTC052956
Website: www.homelandregalia.com, **SMS:** HOMELAND to 56767

Date: 25.09.2023

To
The Environmental Engineer,
Punjab Pollution Control Board,
Regional Office,
Mohali.

Subject: Submission of Environment Audit Report (Form V) for the financial year 2022-23 for the project namely "Homeland Regalia" located at opposite Gurudwara Mata Sundar Kaur, Sector 77, Distt. SAS Nagar (Mohali), Punjab.

Respected Sir,

We are hereby submitting the Environment Audit Report (Form V) for the financial year 2022-23 for the Group Housing Project namely "Homeland Regalia" located at opposite Gurudwara Mata Sundar Kaur, Sector 77, Distt. SAS Nagar (Mohali), Punjab.

All relevant details /documents are enclosed with the report for your kind consideration.

Thanking you
Sincerely

For M. Global Pvt. Ltd.

.....
(Authorized Signatory)
Encl: As above



HOMELAND REGALIA

LIMITED EDITION RESIDENCES

SECTOR 77 MOHALI

+91-99889-76767

SMS 56767 TO "HOMELAND"

FOR MORE DETAILS PLEASE WRITE TO:
INFO@HOMELANDREGALIA.COM

Country

Email address

Telephone

SEND

SALES GALLERY

Group Housing Site, Airport Road,
Sector 77, Sahibzada Ajit Singh Nagar,
Punjab 160070

SMS 56767 to "HOMELAND"

+91-99889-76767



PBRERA-SAS81-PR0757
<https://rera.punjab.gov.in/>

[Privacy Policy](#)

[Compliance Report](#)

[Form V](#)

[Environmental Clearance](#)

Property managed by

Activate Windows
Go to Settings to activate Windows.



RESERVE YOUR REGALIA VISIT



Date: 07.07.2023

STRUCTURAL STABILITY CERTIFICATE

I **Maqsud E Nazar**, Structural Engineer, certify that Proposed Homeland Regalia Situated at Group Housing Site, Sector 77, S.A.S Nagar (Mohali) for M/s S.A. Global Pvt. Ltd., the structural part of entire building shall be designed on the basis of structural calculations and is considered safe in accordance with the permissible stresses, slenderness ratio and soil bearing pressure.

Certified that the building shall be analyzed and designed in accordance with the latest edition of National Building Code and prevailing code of Bureau of Indian standards for Structural Stability and withstand the Earth Quake impact. Further, it does not include implementing structural drawings at the site and ensuring quality during construction in the above mentioned project. The seismic zone considered in design is Zone IV as per IS 1893 part I - 2016.

Signature:

Name of Structural Engineer : Maqsud E Nazar

Qualification : M. Tech (Structures), Ph.D. (Structures)

Registration No. : AM/089710/0

Institution of Engineers



NNC DESIGN INTERNATIONAL

CONSULTING STRUCTURAL ENGINEERS

G-70, 2nd Floor, Jaswant Plaza, Near Kalindi Kunj, Main Sarita Vihar Road, Shaheen Bagh, Okhla, New Delhi-110025

Phone No.: 011- 26940734/35/36 Tele fax: 011- 26940734

E-mails: nnc_consultants@hotmail.com, nnc.mail7@gmail.com, website: www.nncdesigninternational.com



“Pro Active and Responsive facilitation by Interactive, Virtuous and Environmental Singlewindow Hub”

State Environment Impact Assessment
Authority
Punjab



[Home](#) [Services](#) [Blog](#) [Contact Us](#)

S.No	Proposal Details	Location	Important Dates	Category	Company/Proponent	Current status	* Attached Files	View Timeline Detail
1	<p>Proposal No : SIA/PB/INFRA2/438919/2023</p> <p>File No : SEIAA/PB/MIS/2023/EC/51</p> <p>Proposal Name : Expansion of Group Housing Project "Homeland Regalia" by M/s S.A. GLOBAL PVT. LTD.</p>	<p>State : Punjab</p> <p>District :</p> <p>Tehsil :</p>	<p>Date of Submission for TOR :</p> <p>Date of Submission for EC : 27 Oct 2023</p>	INFRA-2	M/S S.A. GLOBAL PVT. LTD.	Accepted by SEIAA and forwarded to SEAC		



S.A. GLOBAL PRIVATE LIMITED

Regd. Office: Group Housing Site, Sector 77, SAS Nagar, Mohali - 140308, Punjab, India
M: 79863 53802, E-mail: saglobal@homelandregalia.com, CIN: U51225PB2016PTC052956
Website: www.homelandregalia.com, SMS: HOMELAND to 56767

Date: 31.08.2023

To,

The Member Secretary,

State Environment Impact Assessment Authority (SEIAA),

Directorate of Environment and Climate Change,

C/o Punjab State Council for Science & Technology,

MGSIPA Complex,

Sector-26, Chandigarh-160019.

Subject: - Regarding Environmental Clearance for Expansion of Group Housing Project namely "Homeland Regalia" at Sector 77, Distt. SAS Nagar (Mohali), Punjab by M/s SA Global Pvt. Ltd.

Ref.No.: EC Letter granted vide F. No. 21-110/2020-IA-III dated 23.02.2021

Respected Sir,

This is in reference to the above mentioned EC letter, we are herewith submitting EC application for Expansion of Group Housing Project namely "Homeland Regalia" at Sector 77, Distt. SAS Nagar (Mohali), Punjab.

The project has already obtained Environmental Clearance from MoEF&CC in the name of "Homeland Residences" for 303 Residential Flats and 18 Shops having built-up area of 1,00,287.509 sq.m. in the plot area of 4.58 acres. Later, planning of the project has been changed within the same plot area in such a way that no. of Flats will be reduced from 303 to 279 flats, Shops will be increased from 18 to 23 shops and there will be addition of 2 Club Houses. Accordingly, built-up area will be increased from 1,00,287.509 sq.m. to 1,33,113.924 sq.m. Also, name of the project has been changed from "Homeland Residences" to "Homeland Regalia".

After expansion, the total built-up area of the project will be 1,33,113.924 sq.m, thus project falls under Schedule 8(a); Category B2 (as per EIA notification dated 14th September, 2006 and amendments till date). Hence, application is being filed to SEIAA, Punjab for expansion of Group Housing Project.



HOMELAND REGALIA

Further, as per Notification No. 10/167/2013-STE(5)/1510178/1 dated 27.06.2019, the processing fees for Environmental Clearance of "Building & Construction Projects" is Rs.2 per sq.m. of built-up area. As the increased built-up area of the project is 32,826.415sq.m., thus, processing fee for expansion will be Rs. 65,652.83/- Say Rs.65,660/- (Rs.2*32,826.415= Rs.65,652.83/-).

Thus, Rs. 65,660/- has been paid in two transactions i.e. Rs. 65,640/- paid vide UTR No. UBIN0903191 dated 23.08.2023 &Rs. 20/- paid vide UTR no. 324364936483 dated 31/08/2023 through NEFT mode.

Also, we are hereby enclosing Checklist, Conceptual Plan, EMP, Form-I/IA along with requisite Annexures and Drawings as per contents of above said project.

We kindly request you to process our application and grant us Environmental Clearance at the earliest.

Thanking you,

Sincerely,

For M/s.A. Global Pvt.Ltd.

Gurpreet Singh
(Authorized Signatory)

Handwritten signature
20/09/23

Encl: As above